



Locking cylinder (Z4) HZ, HZ DK, MR

Z54.0.90536
23.04.2024

- DE Kurzanleitung
- EN Quick guide
- FR Guide abrégé
- NL Korte handleiding
- IT Guida breve
- DK Korte vejledning
- SK Snábguide



3. Variants



5. Installing the HZ cylinder

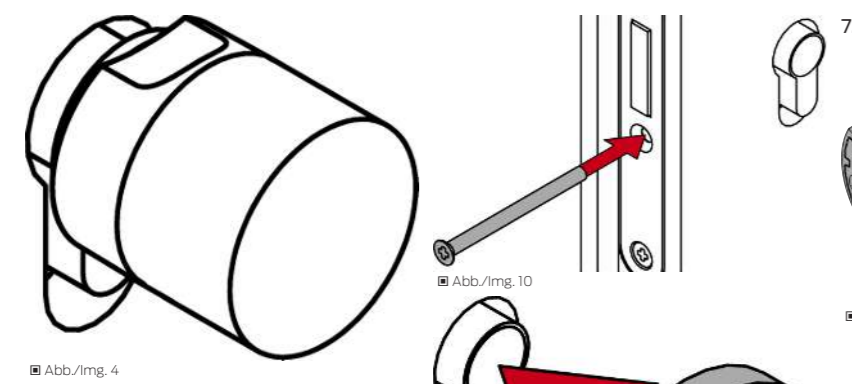
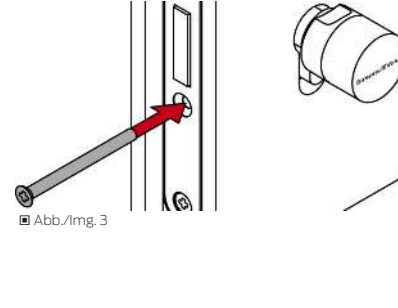
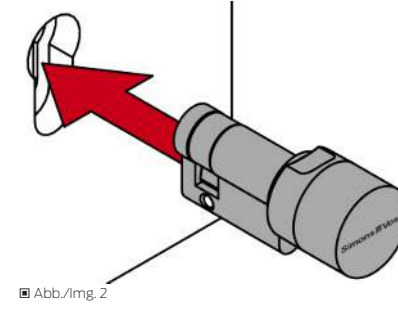

6. Installing the HZ DK cylinder

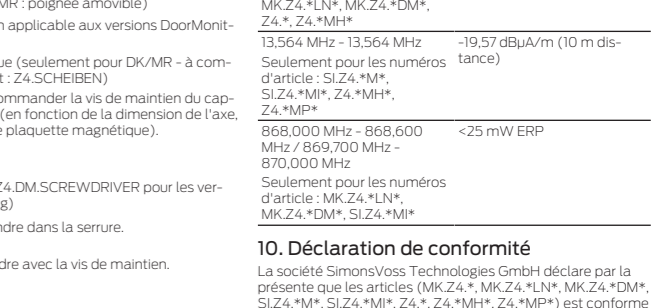
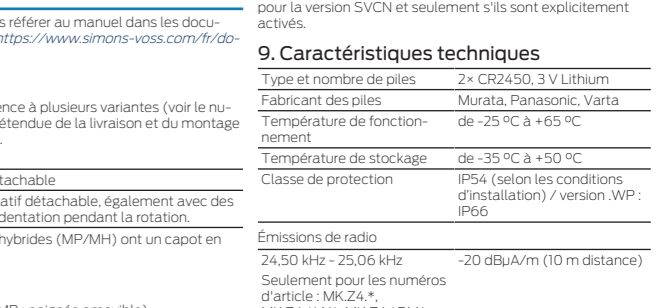
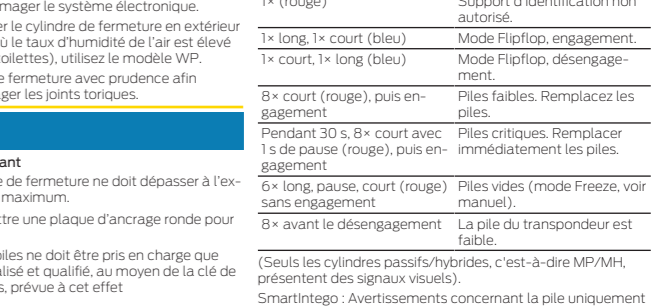
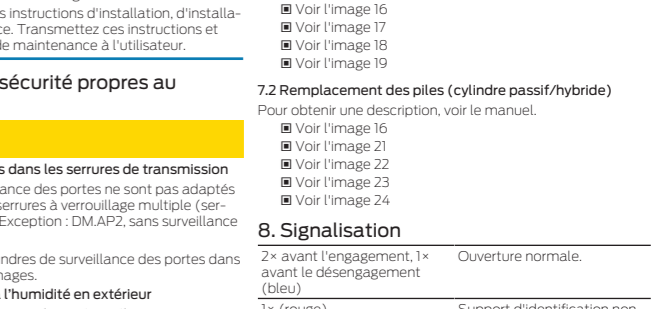
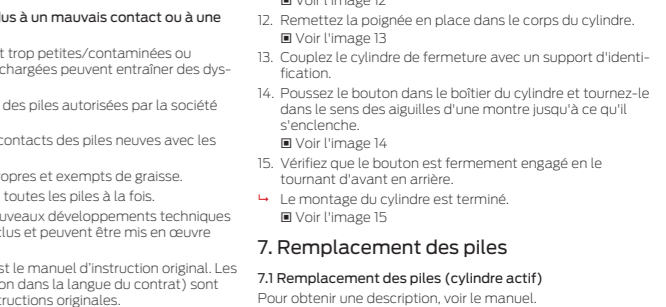
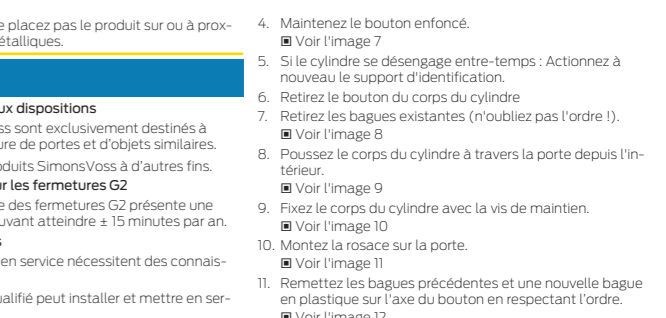
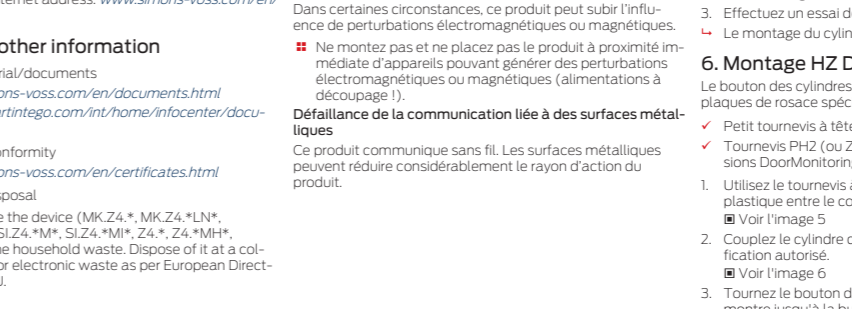
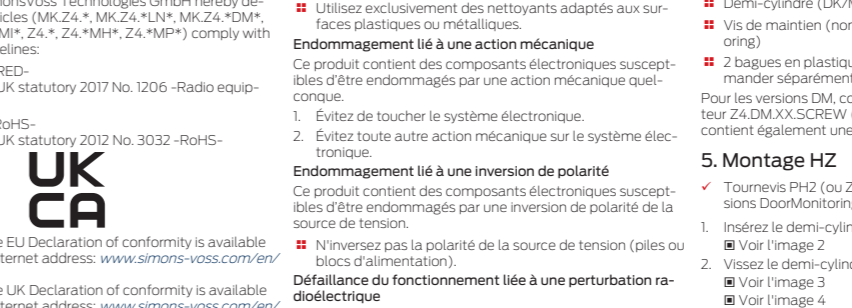
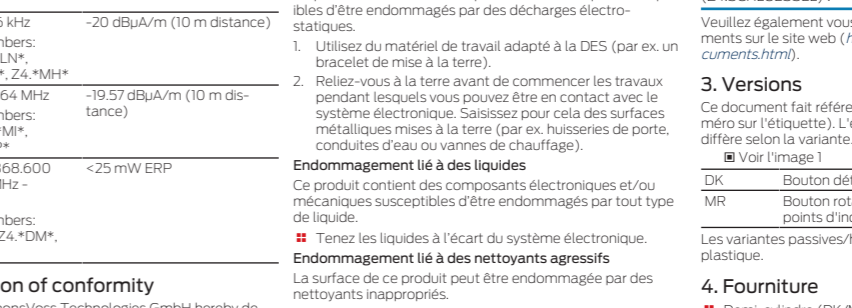
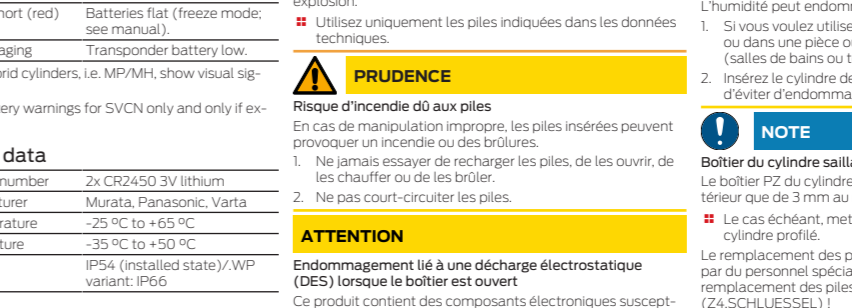
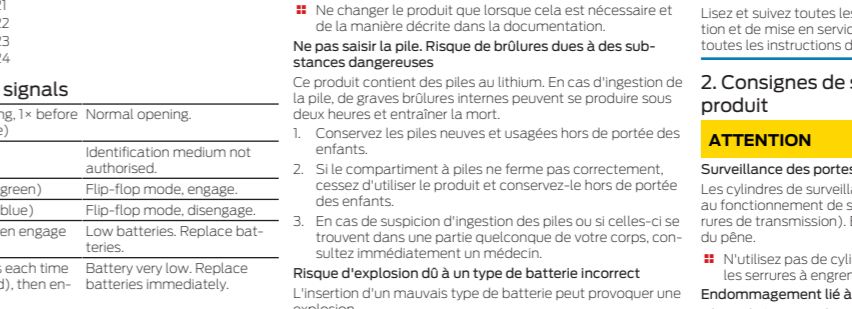
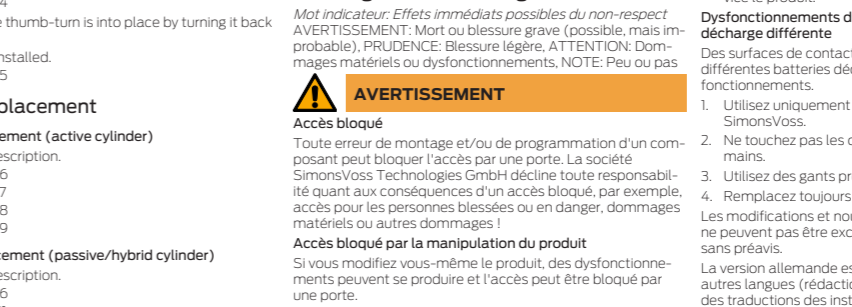
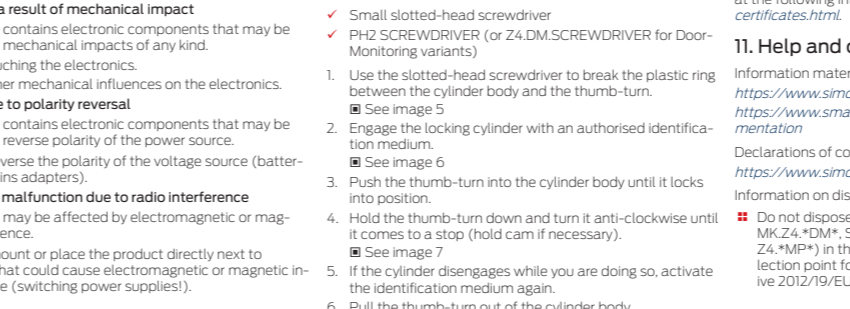
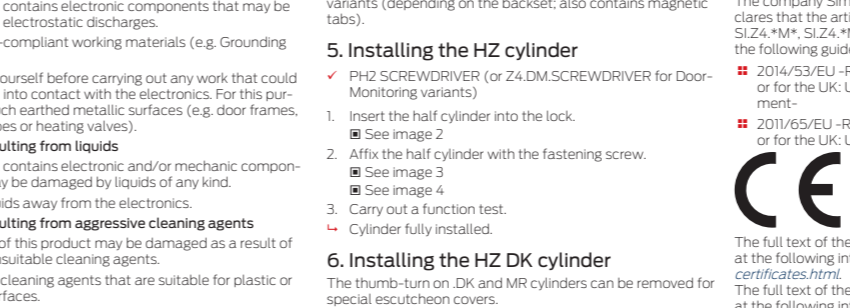
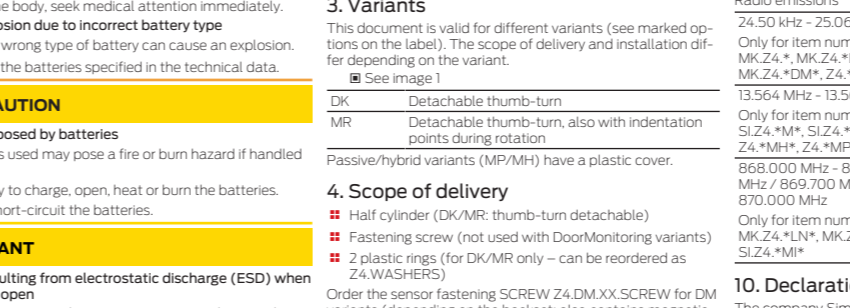
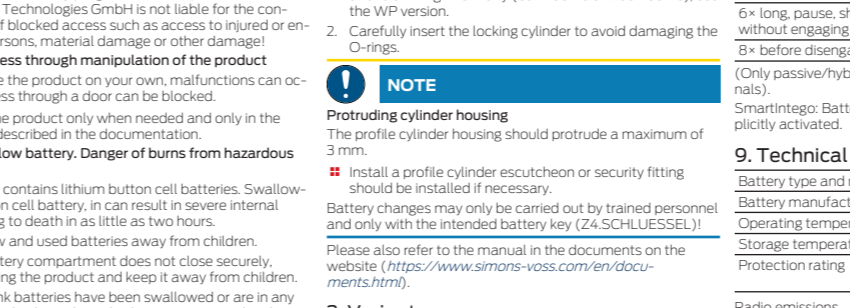
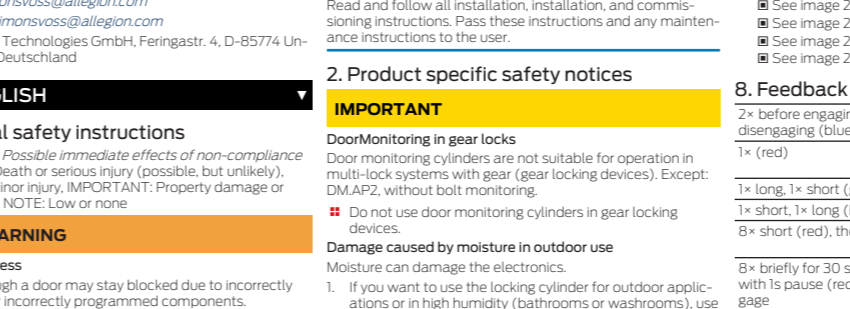
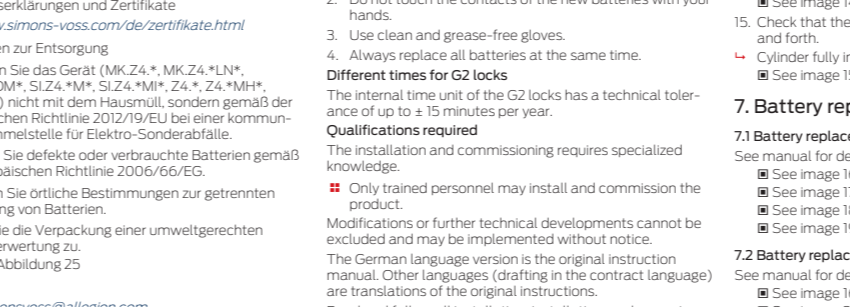
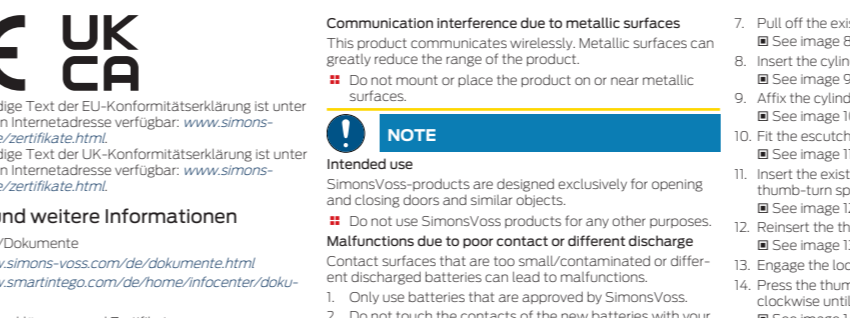
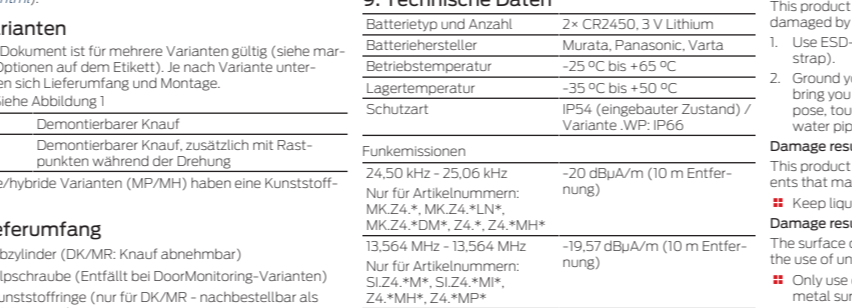
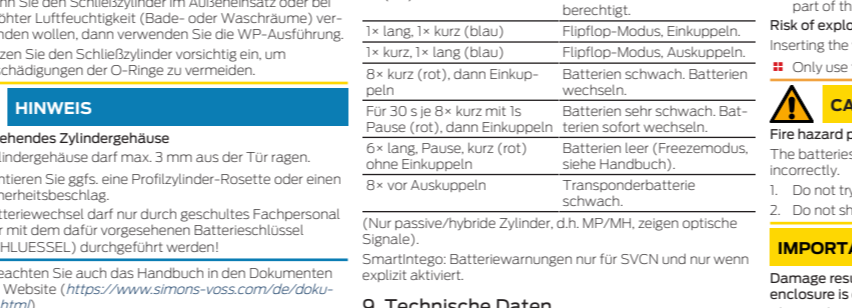
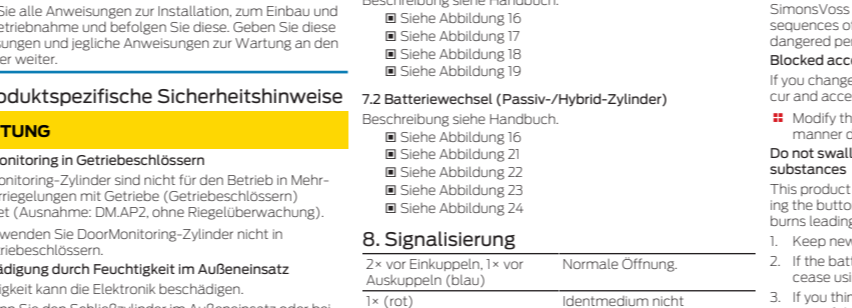
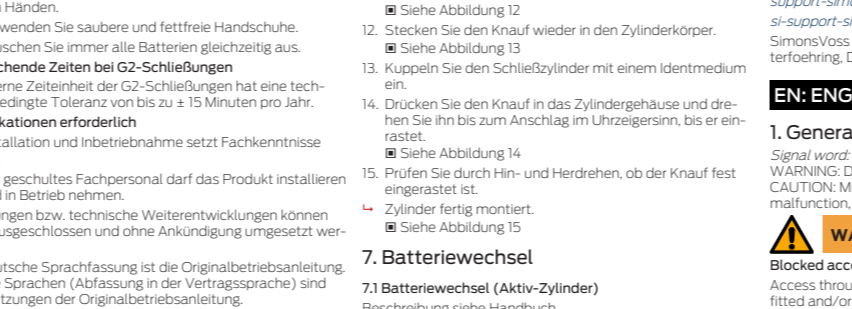
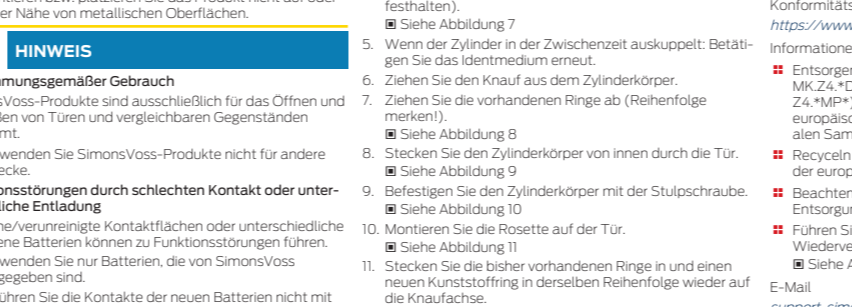
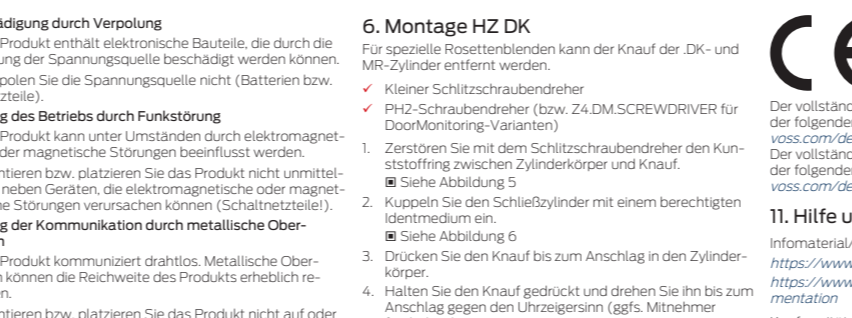
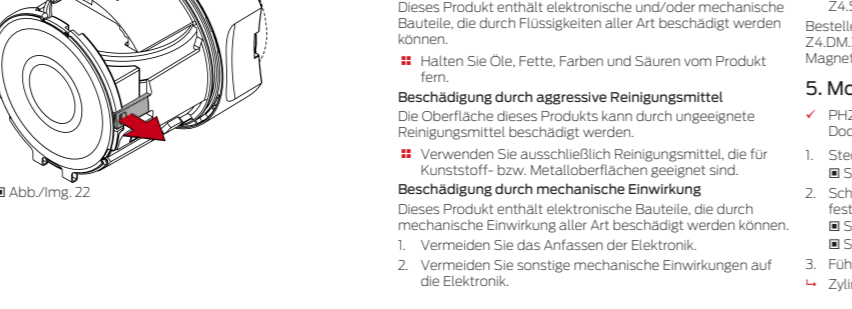
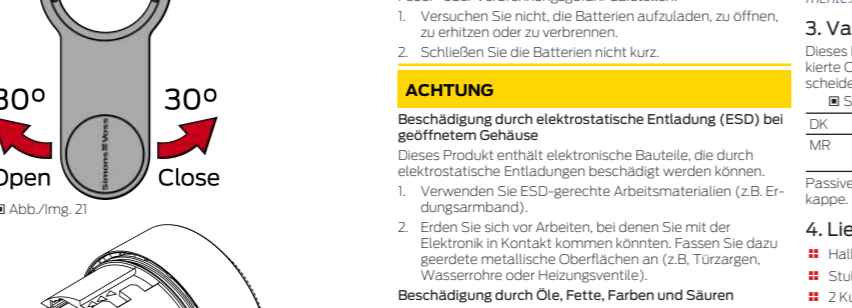
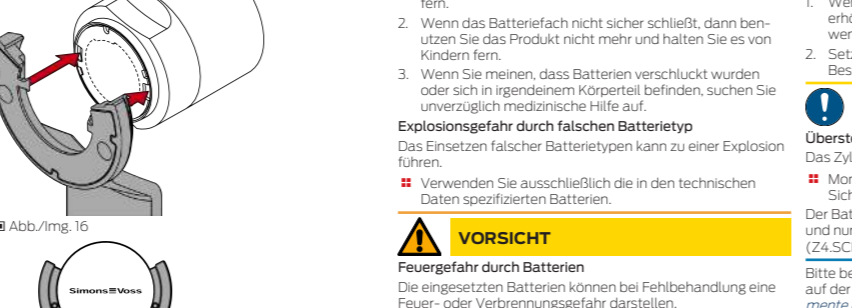
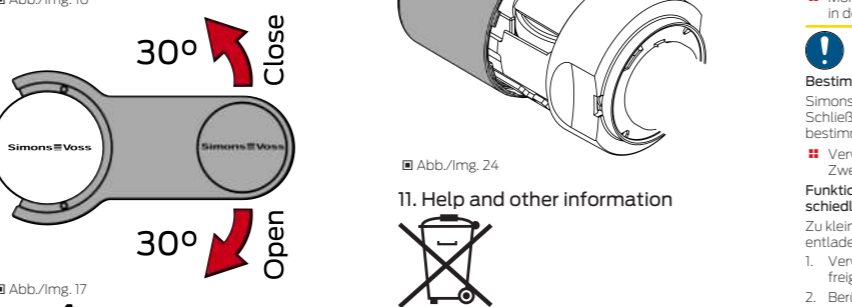
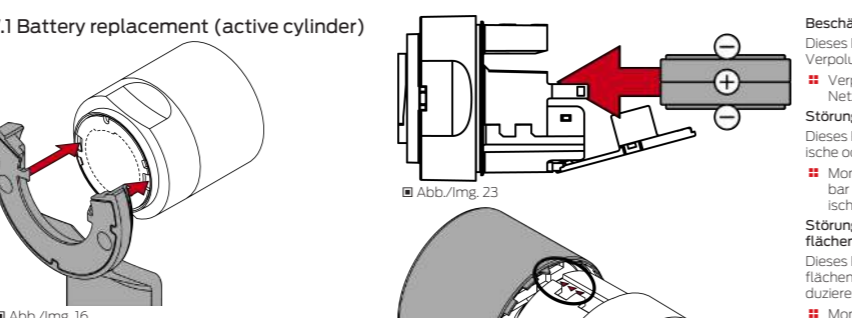
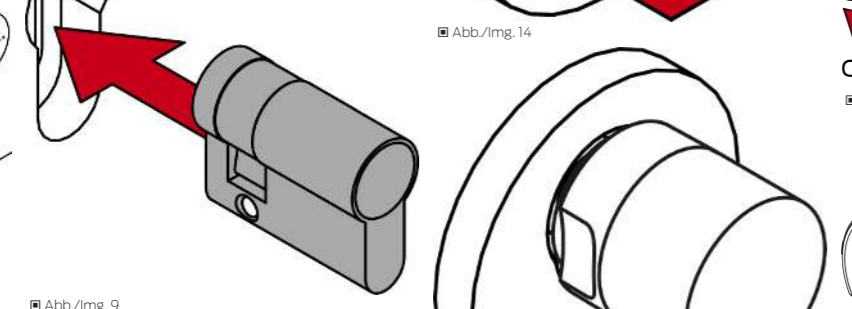
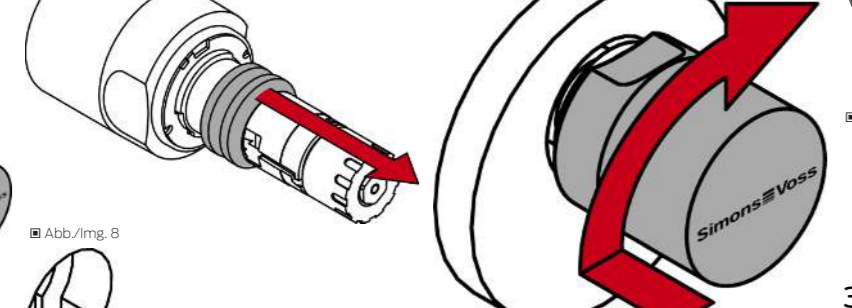
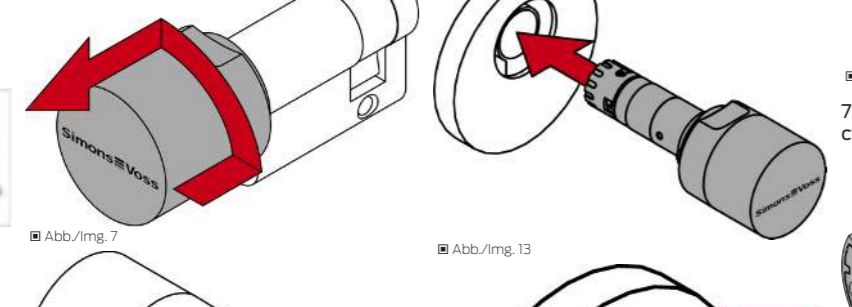
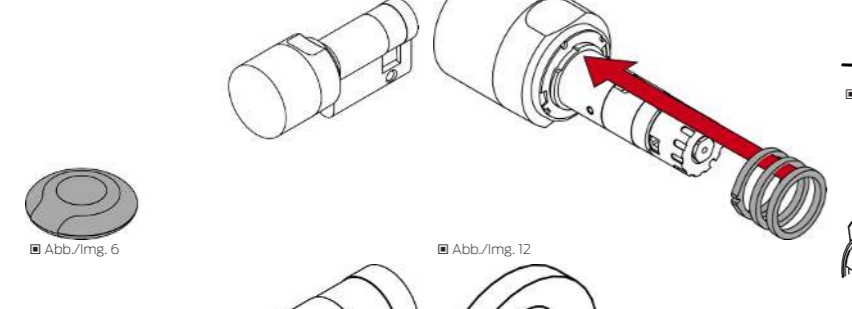
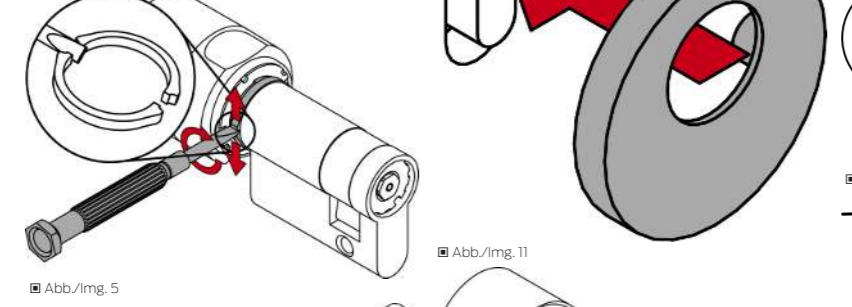

7.1 Battery replacement (active cylinder)

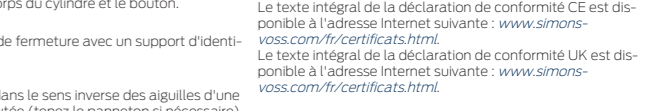
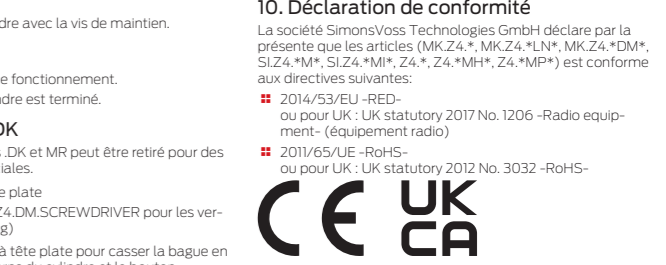
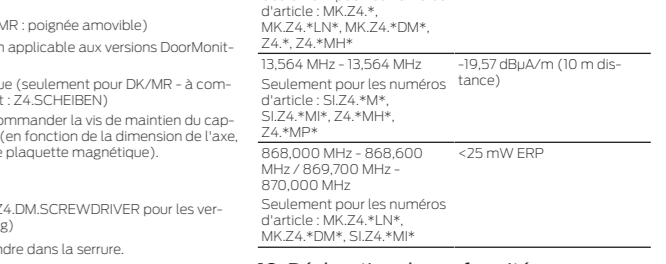
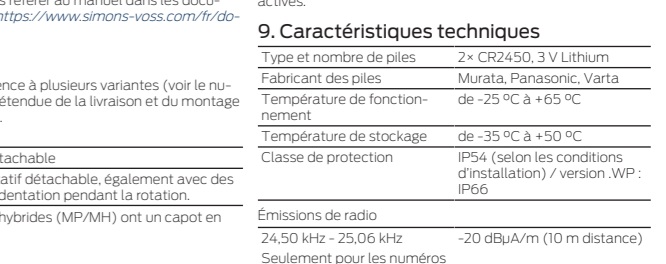
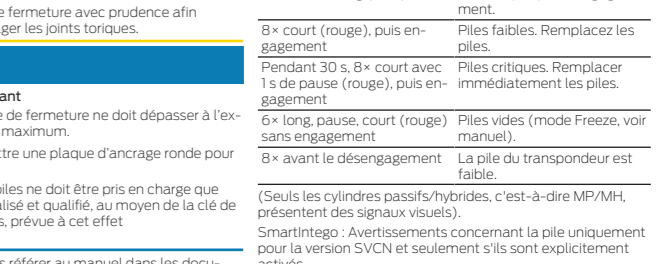
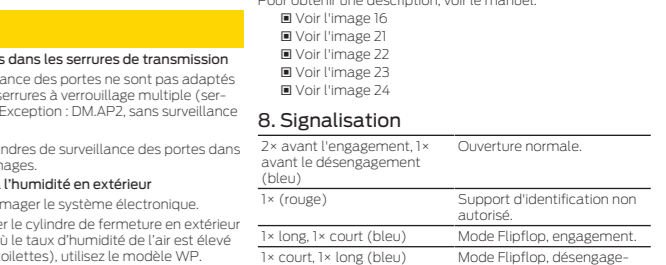
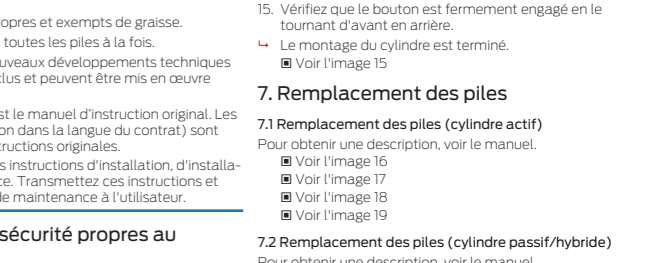
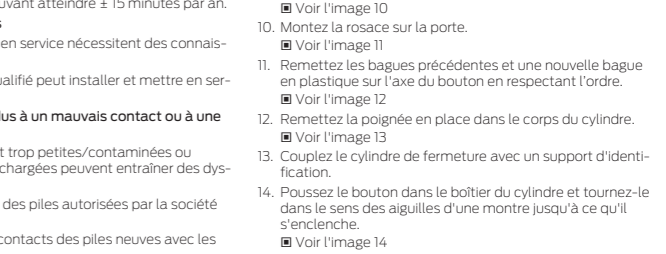
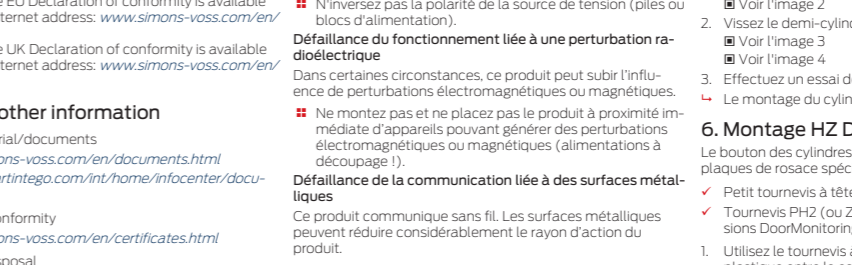
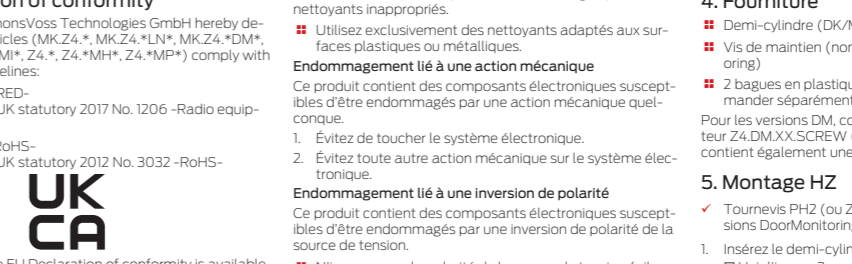
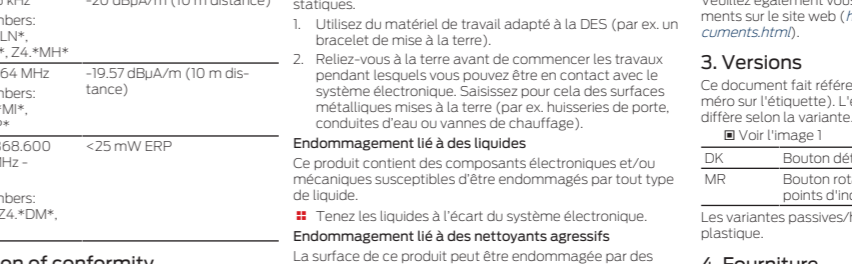
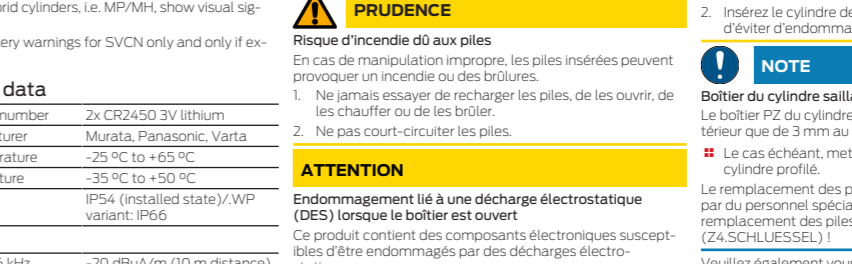
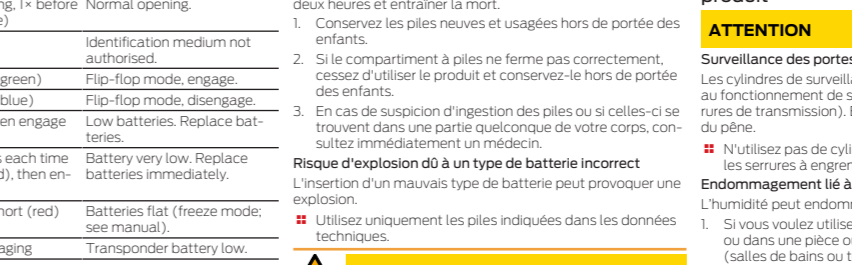
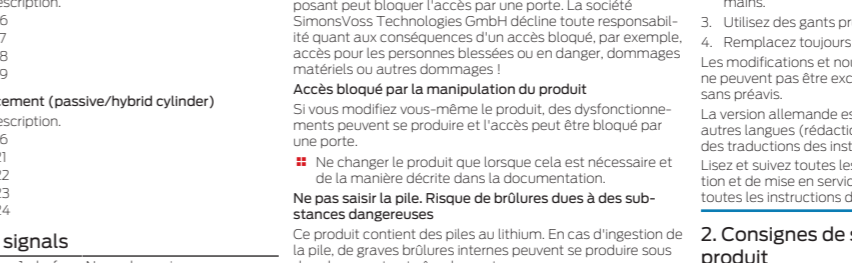
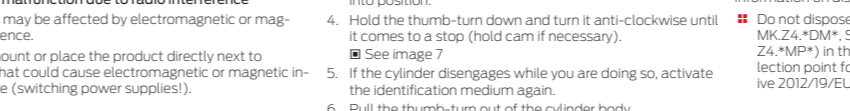
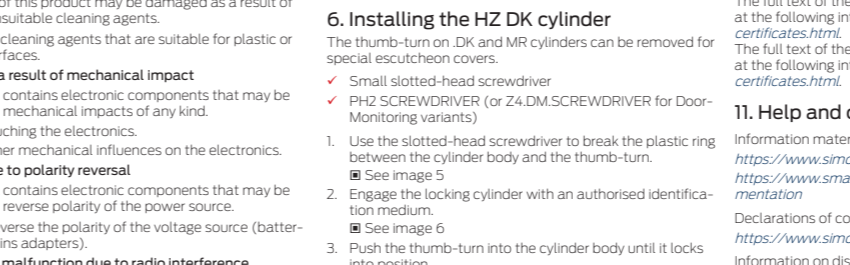
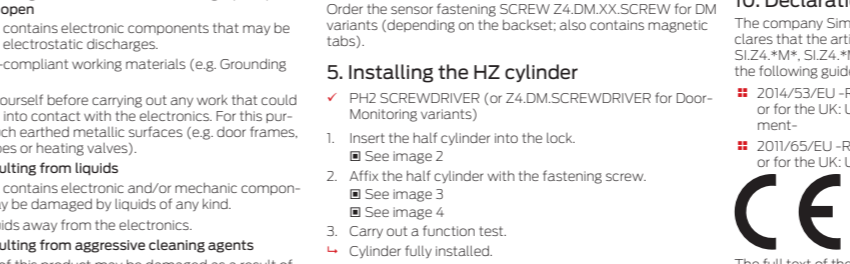
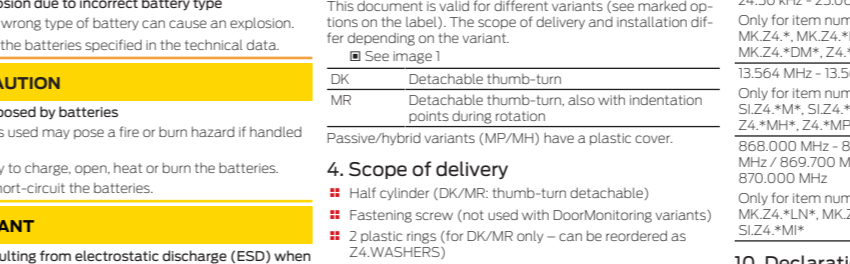
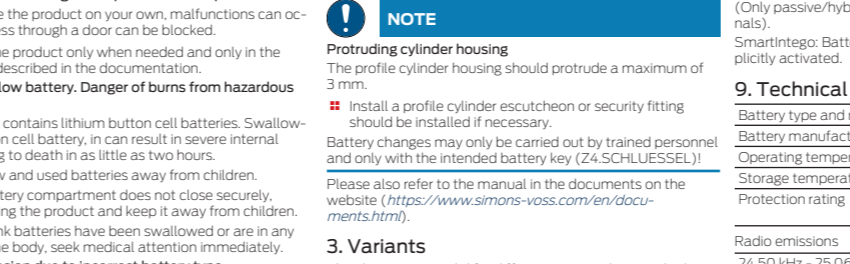
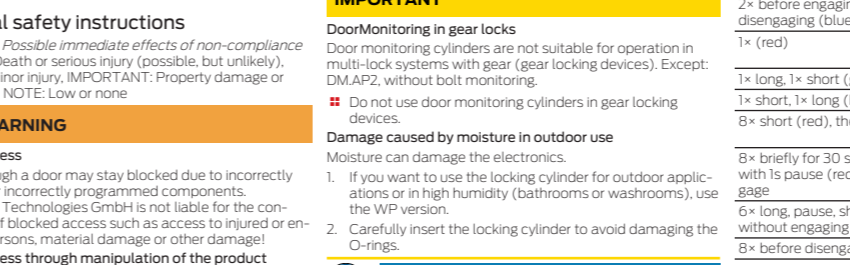
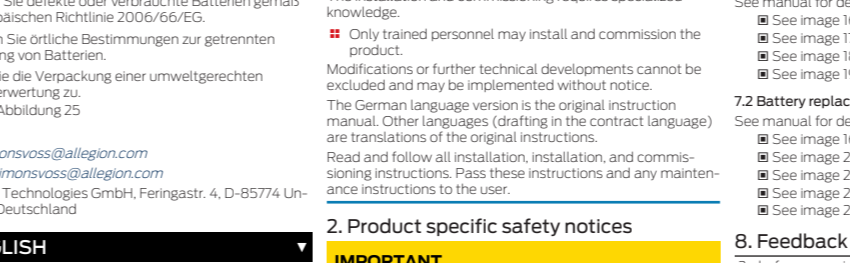
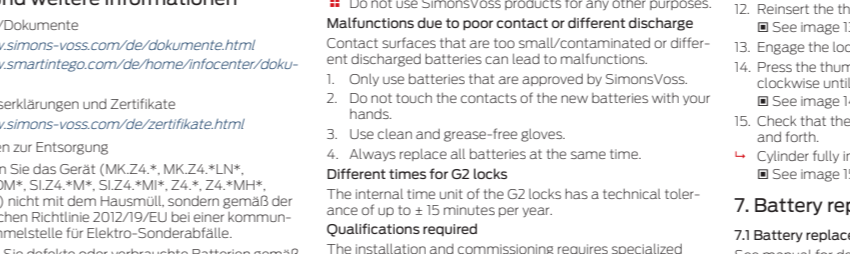
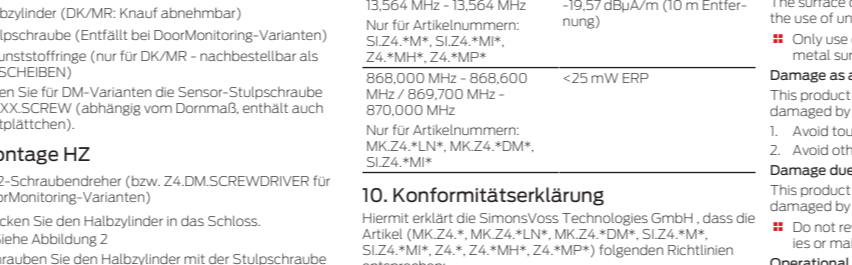
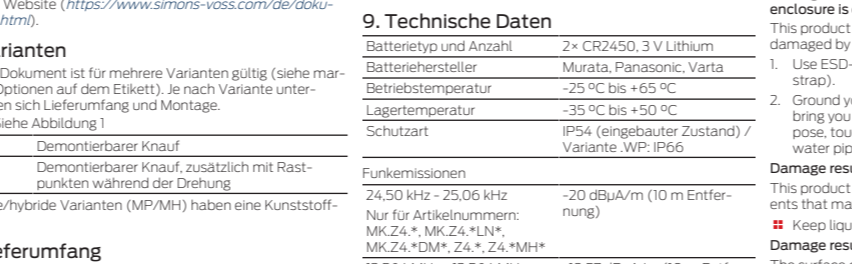
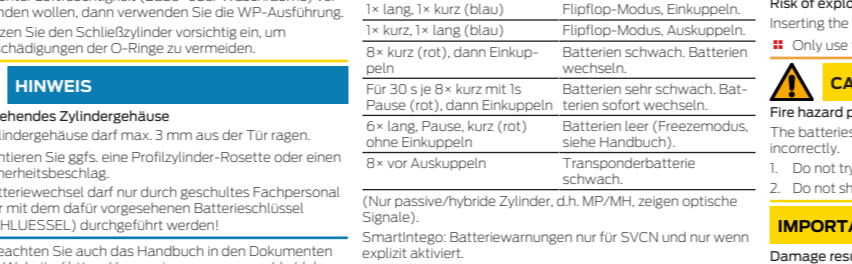
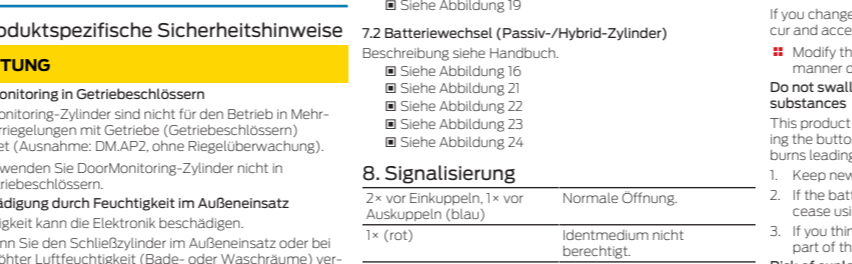
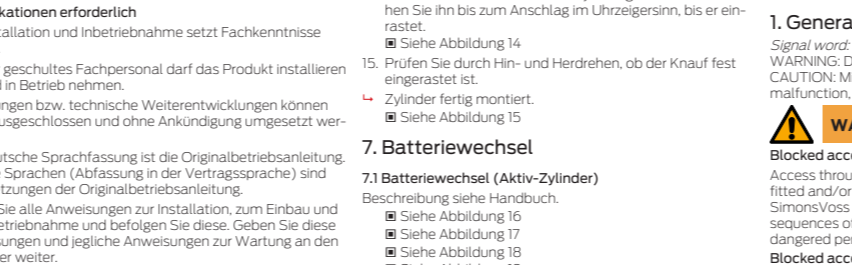
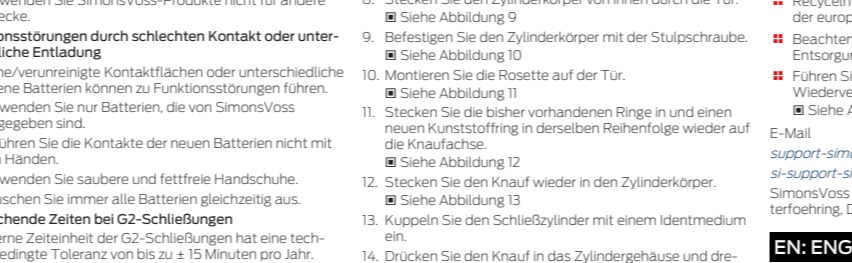
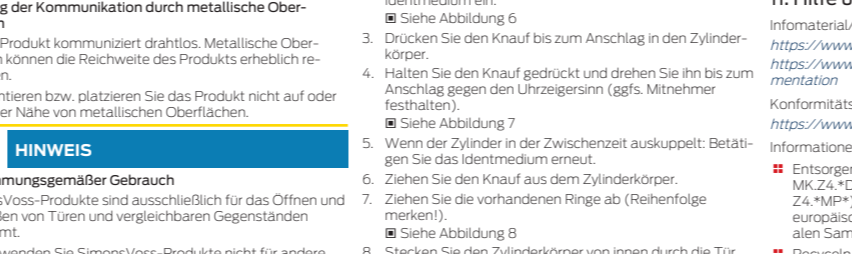
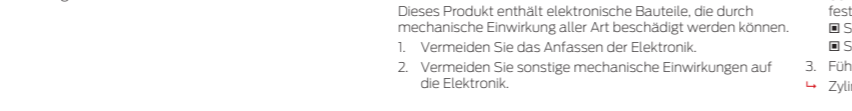
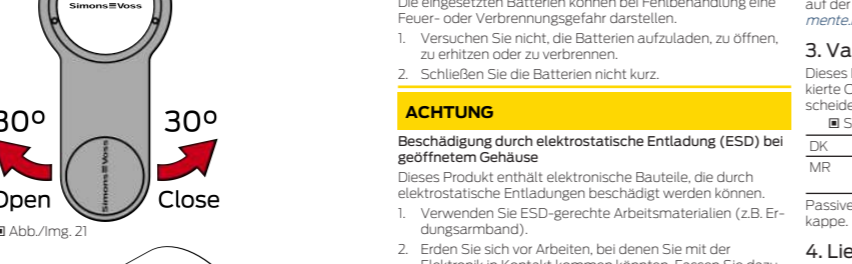
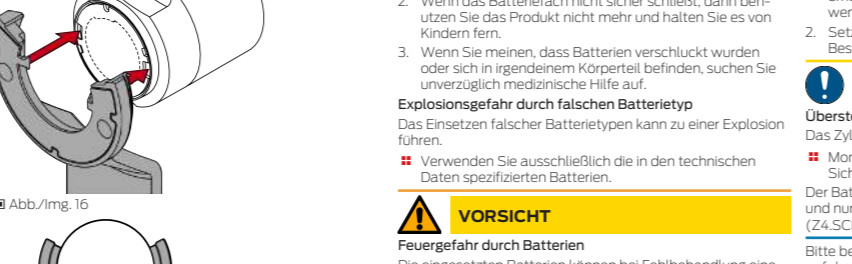
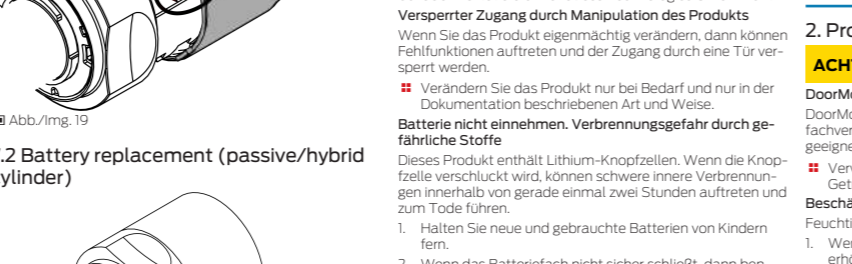
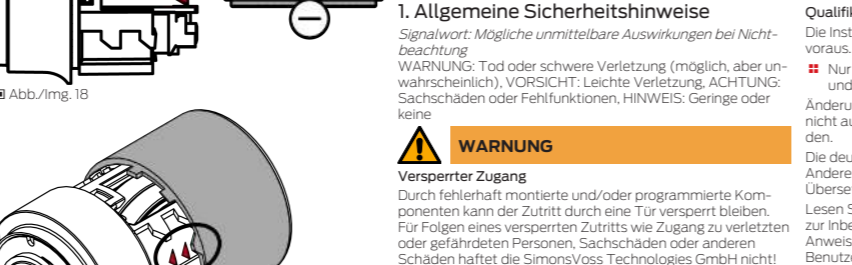
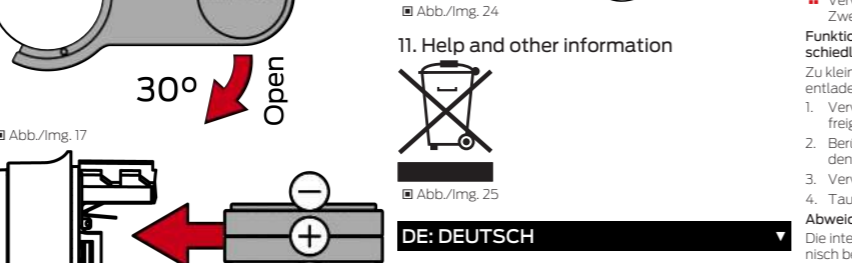
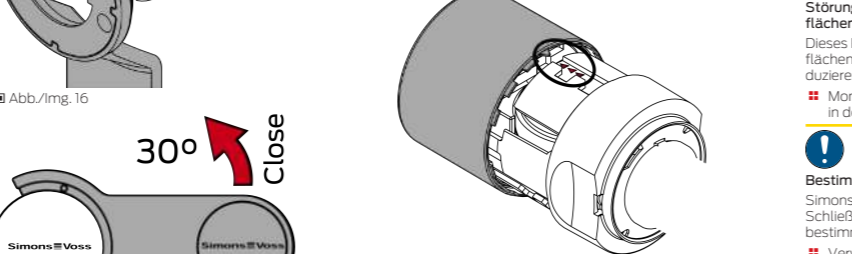
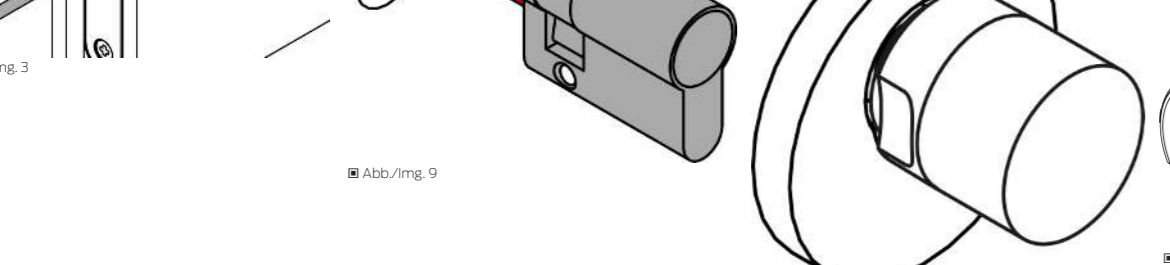
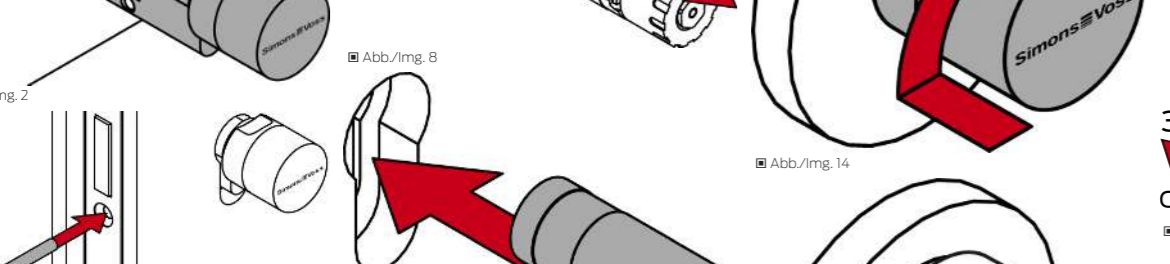
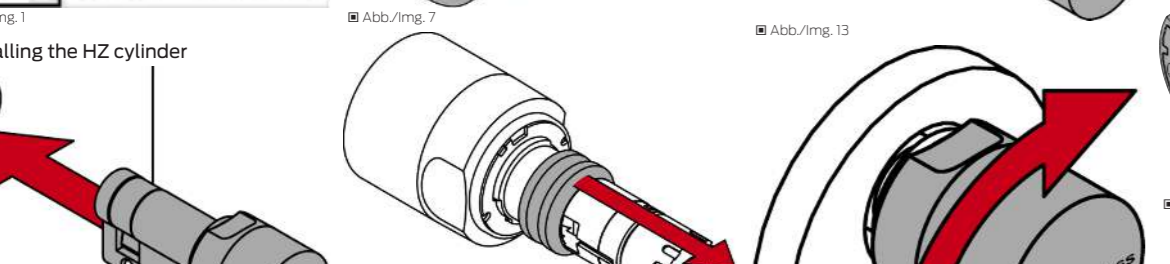
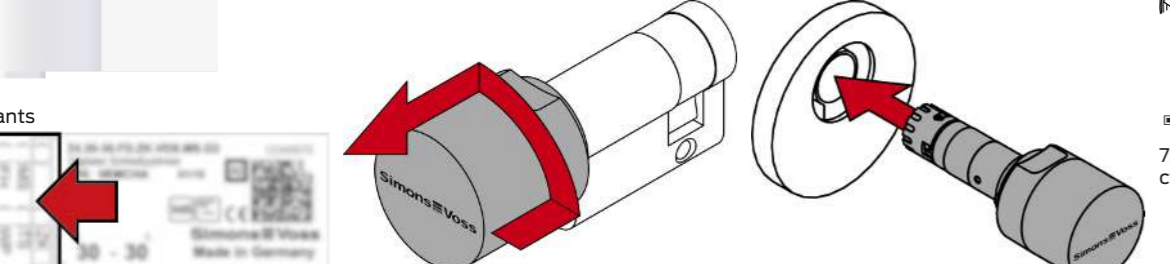
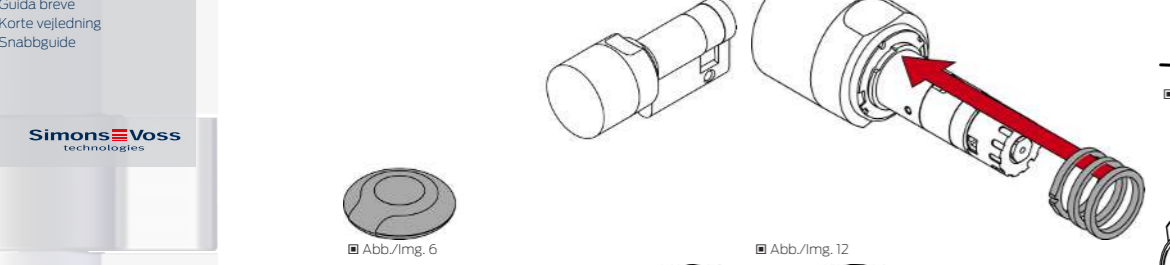
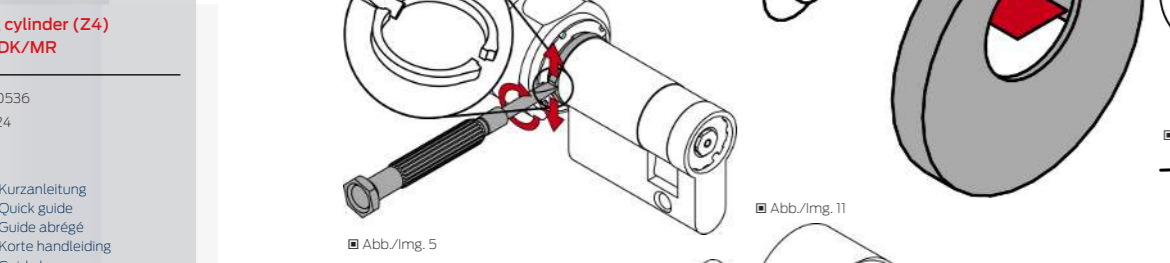
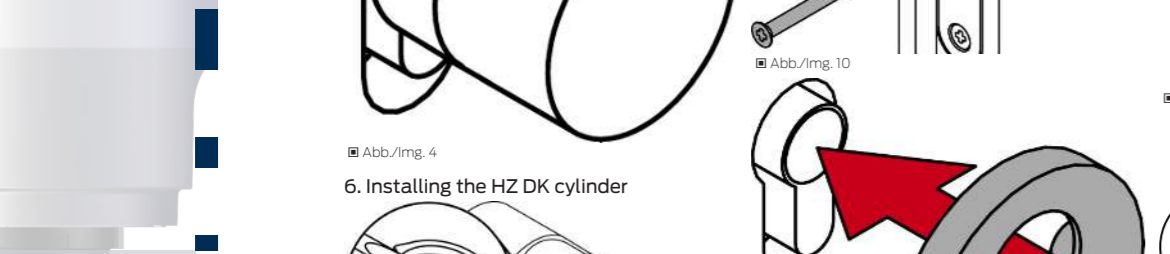

7.2 Battery replacement (passive/hybrid cylinder)

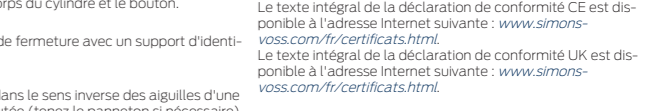
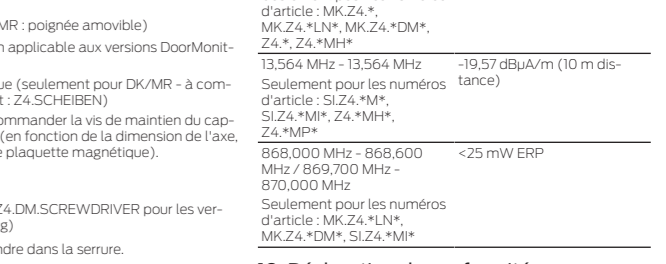
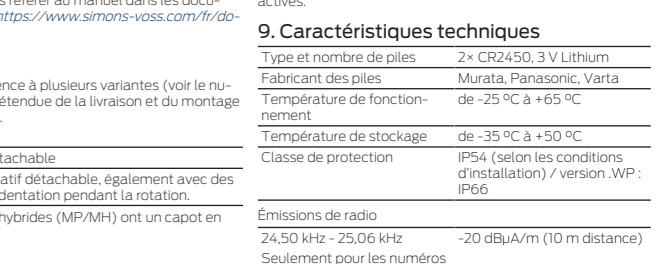
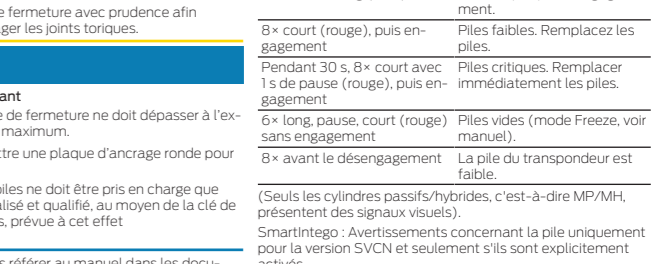
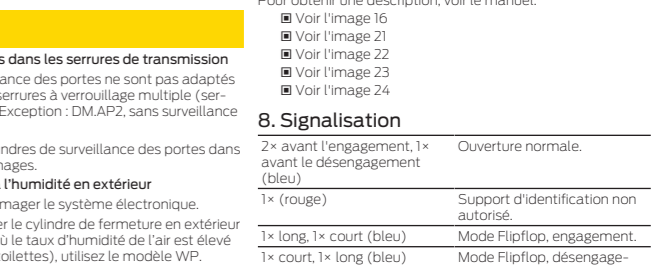
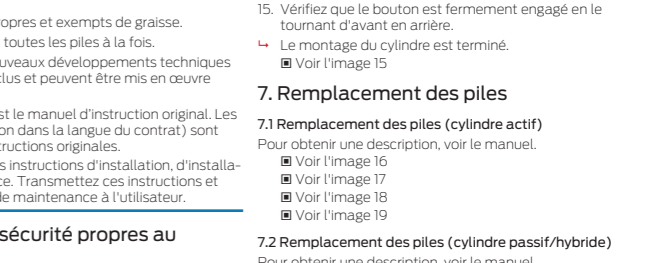
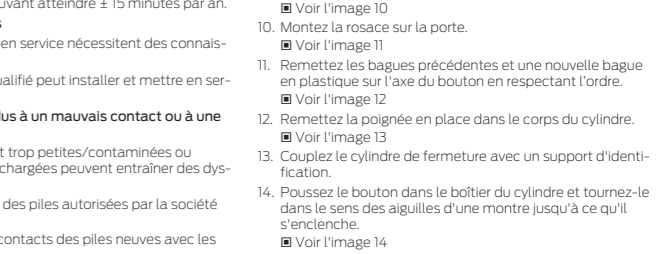
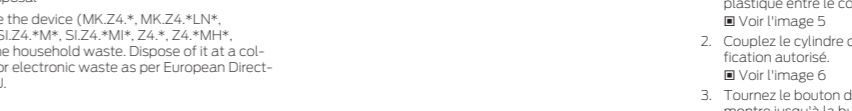
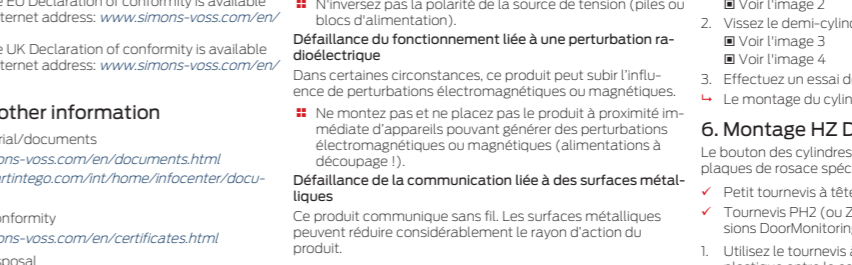
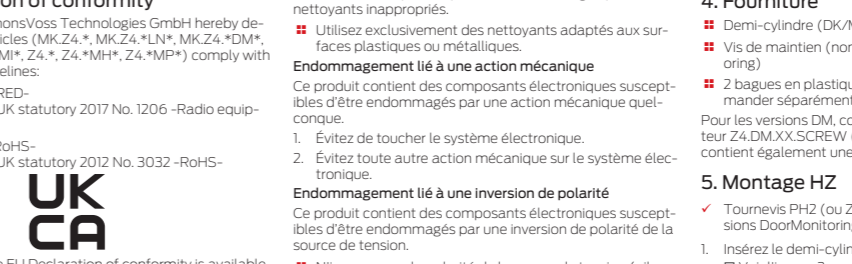
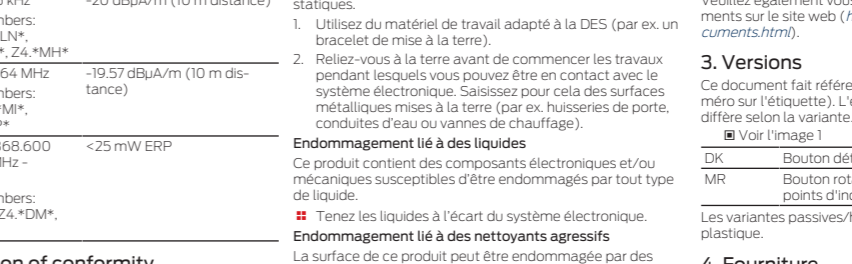
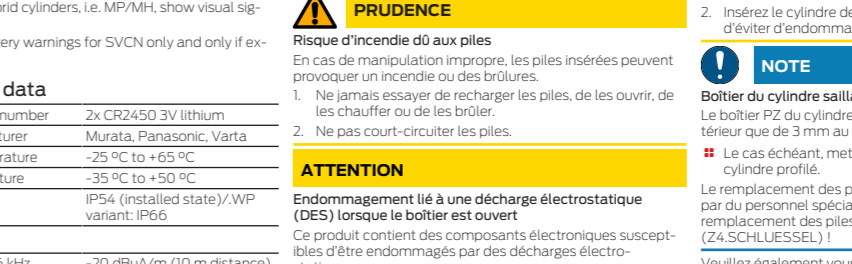
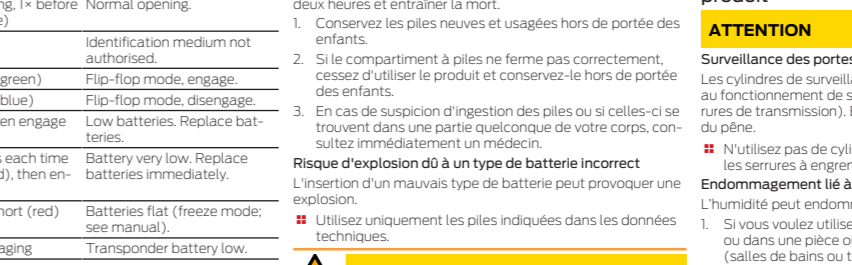
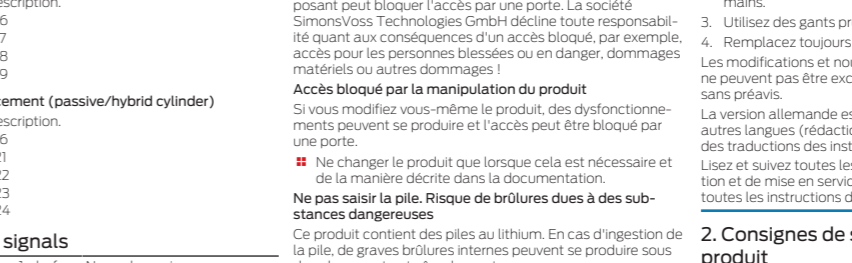
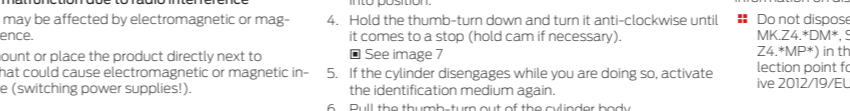
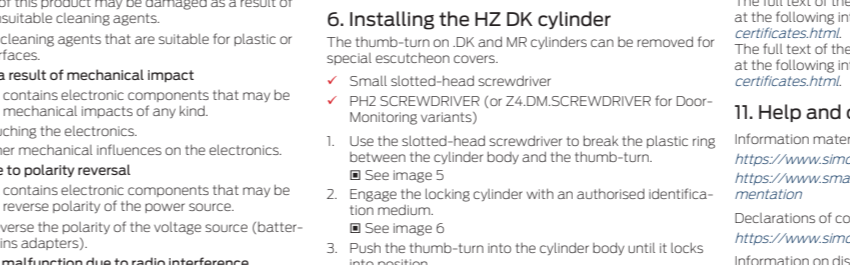
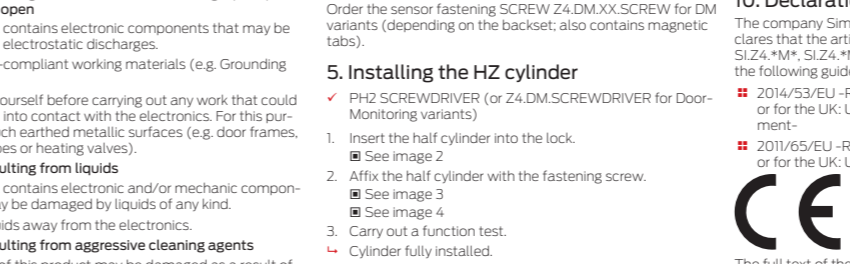
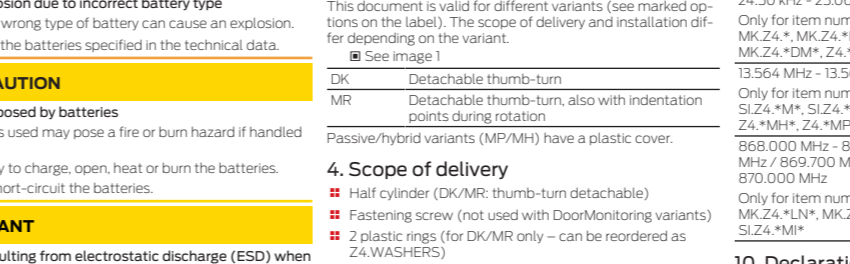
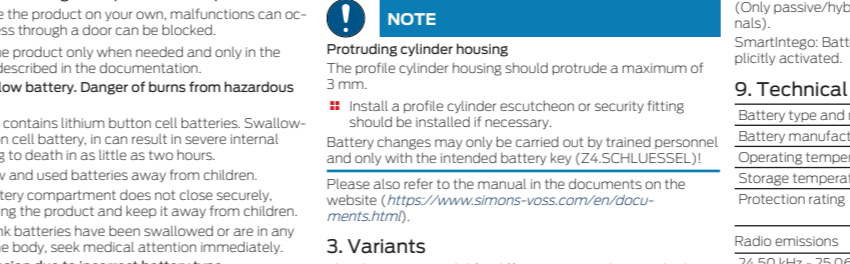
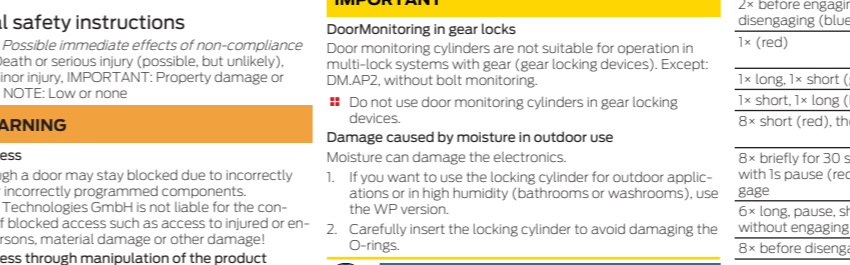
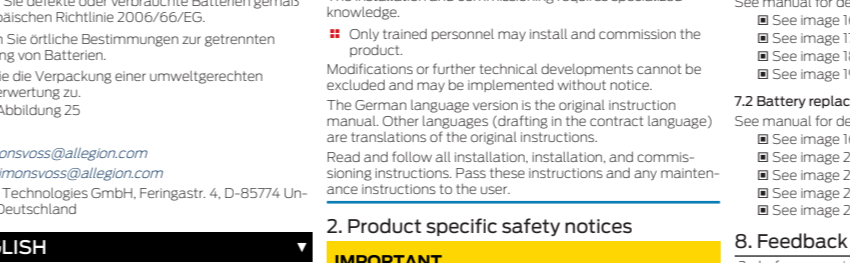
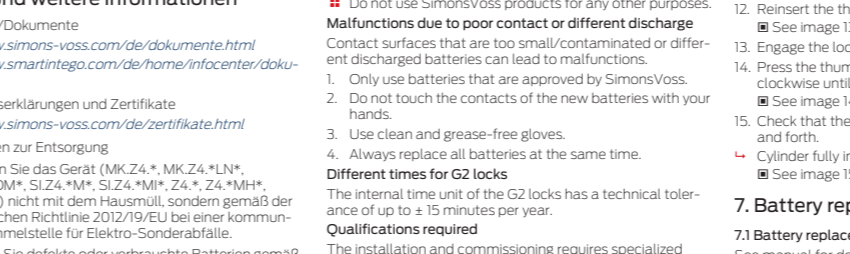
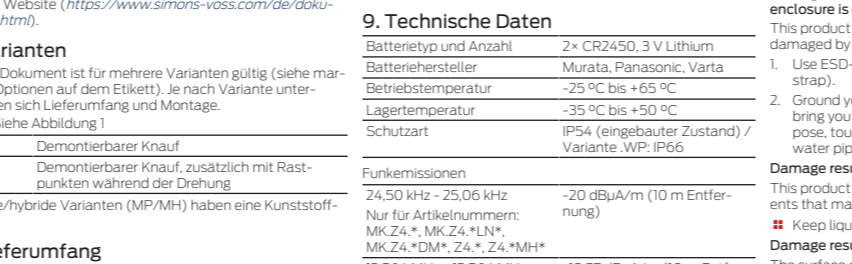
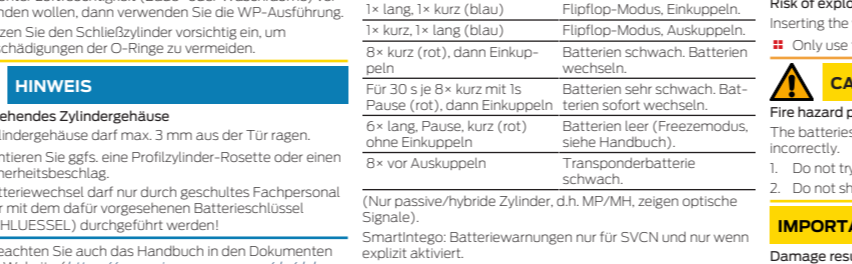
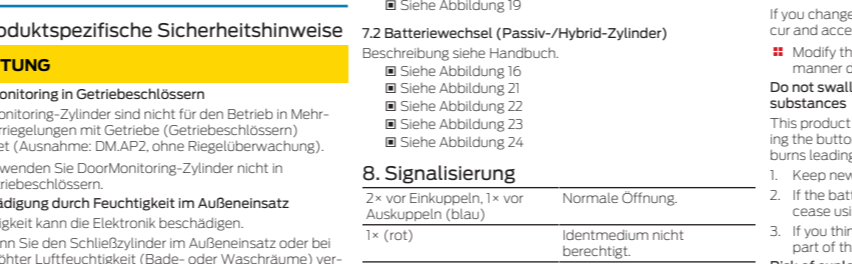
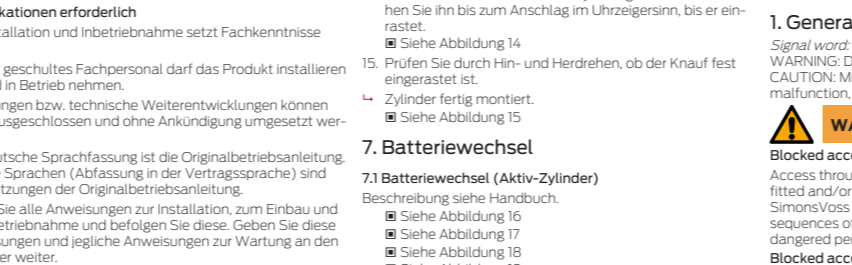
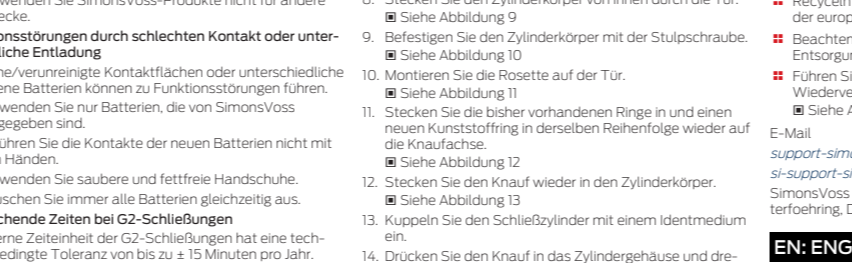
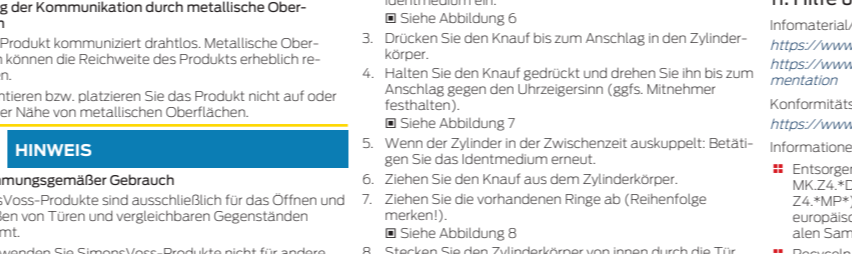
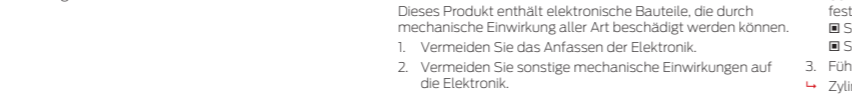
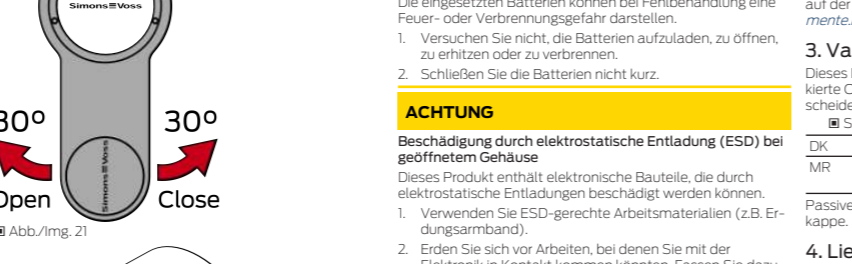
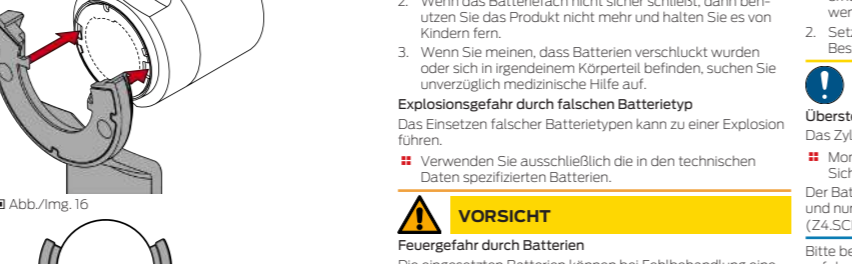
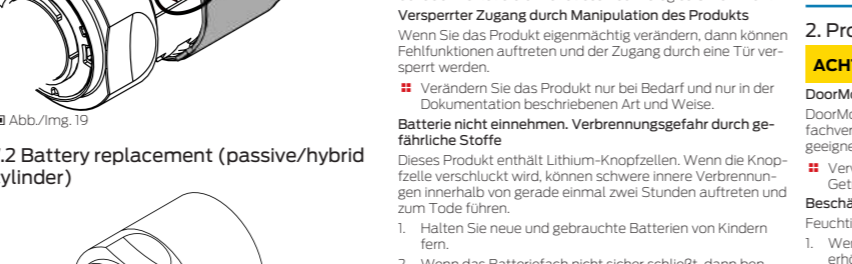
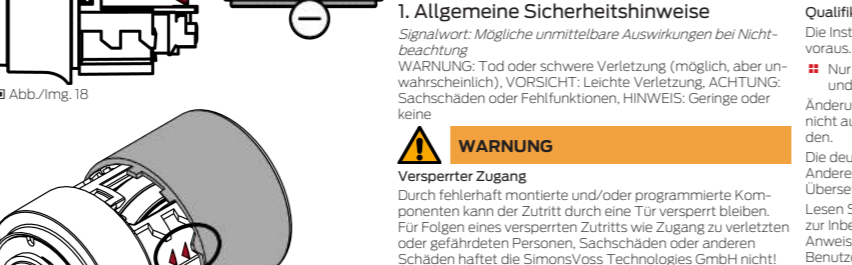
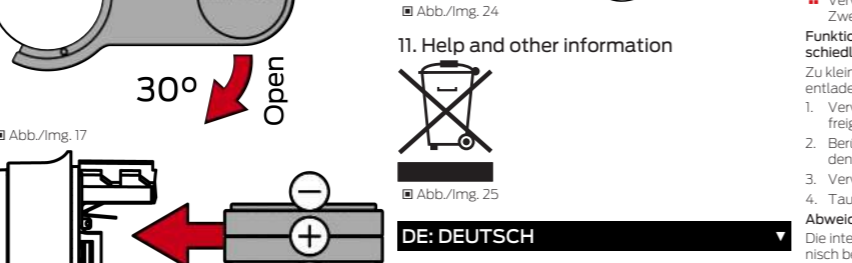
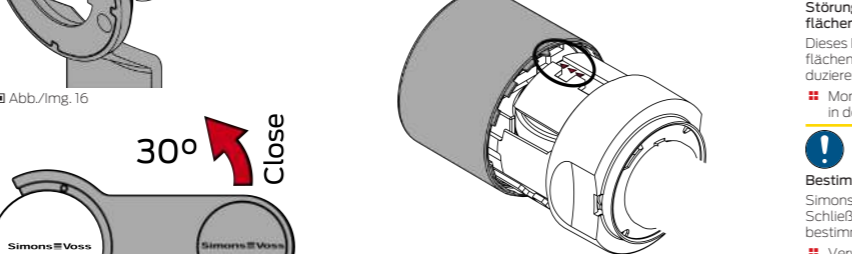
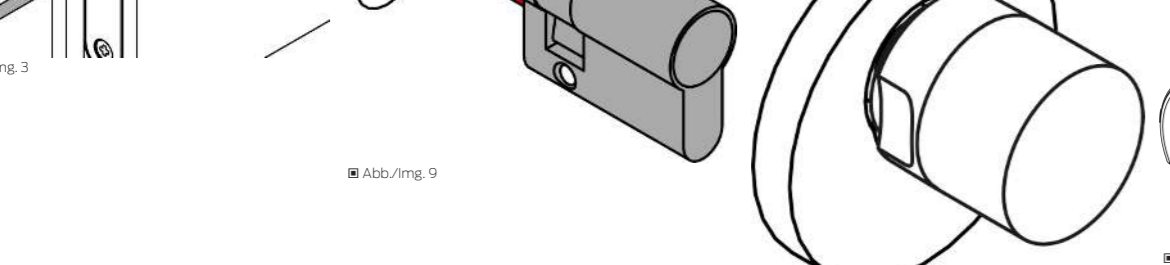
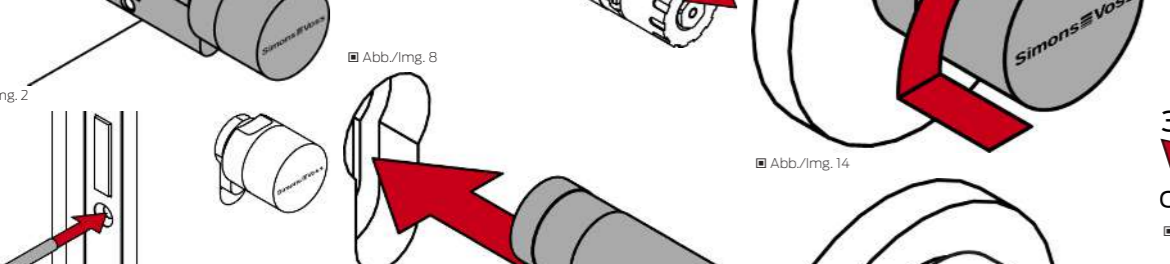
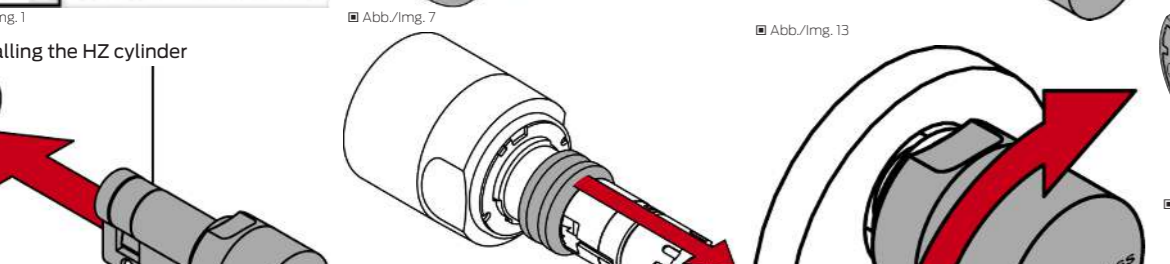
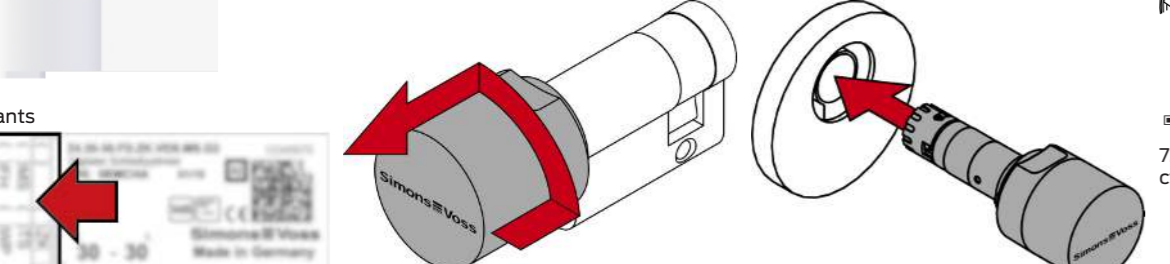
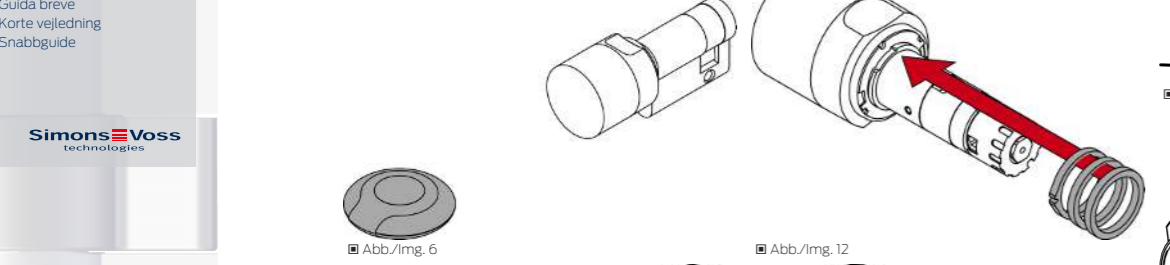
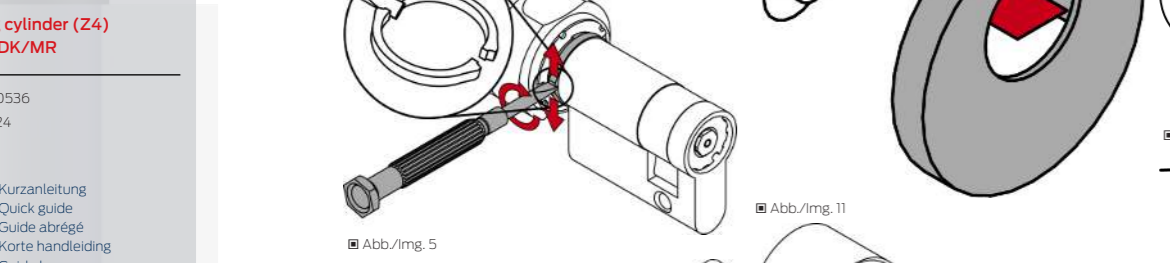

7.3 Battery replacement (active cylinder)

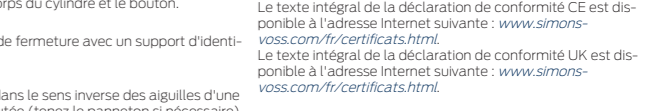
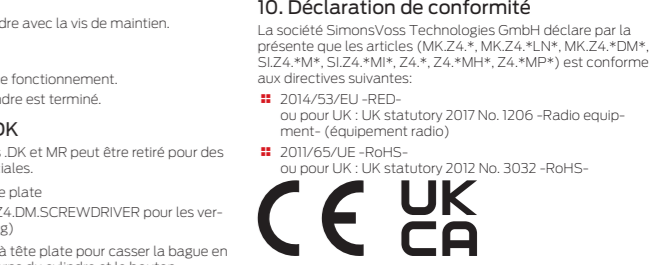
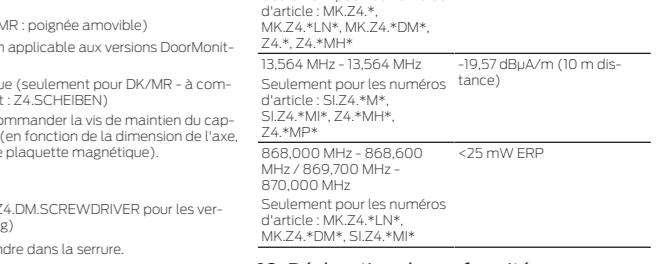
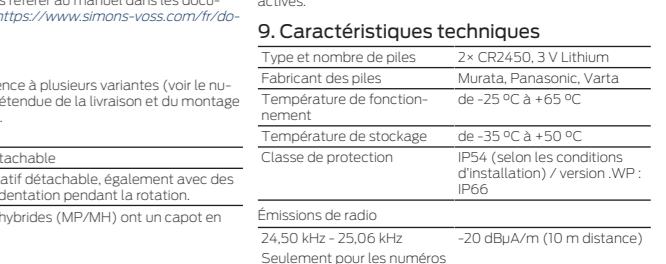
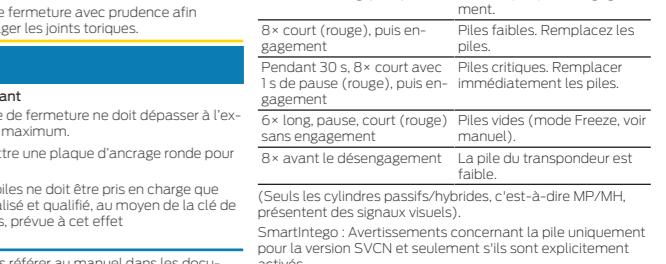
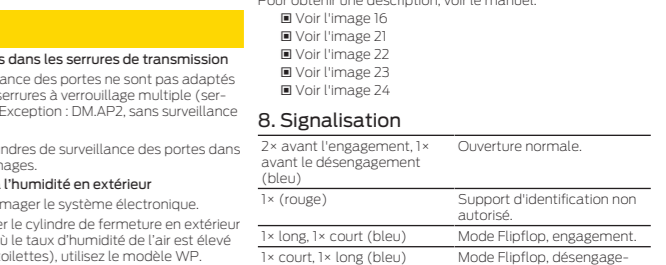
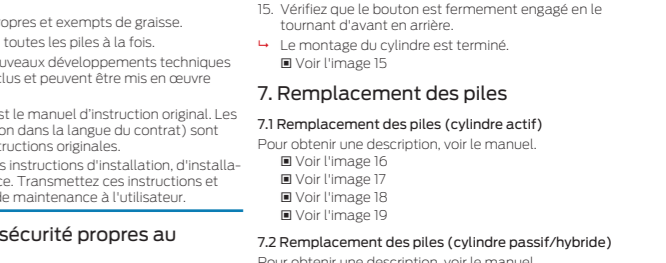
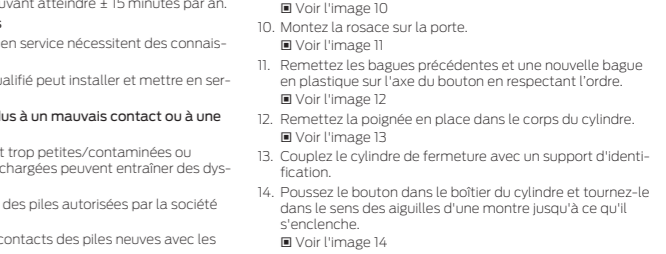
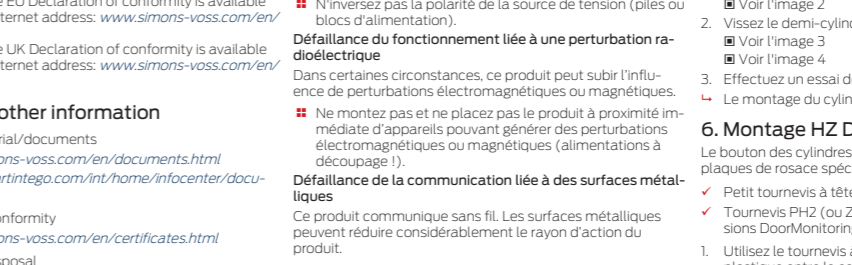
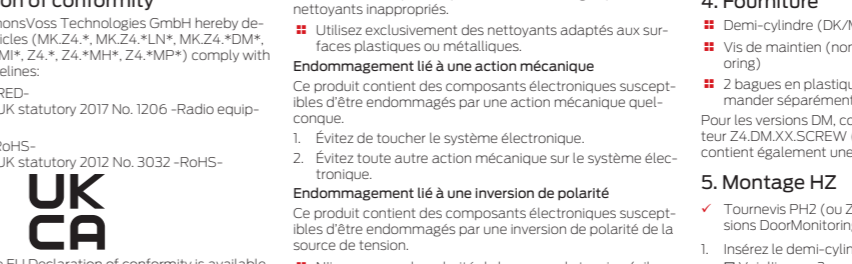
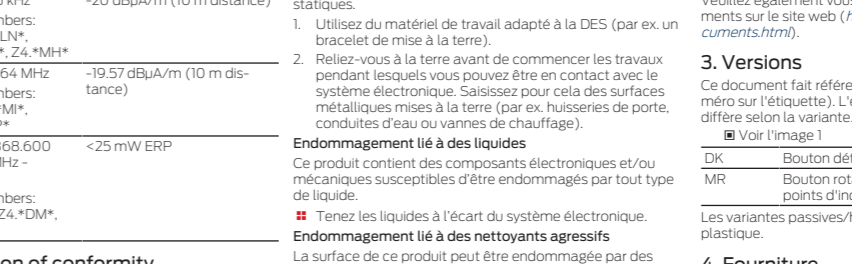
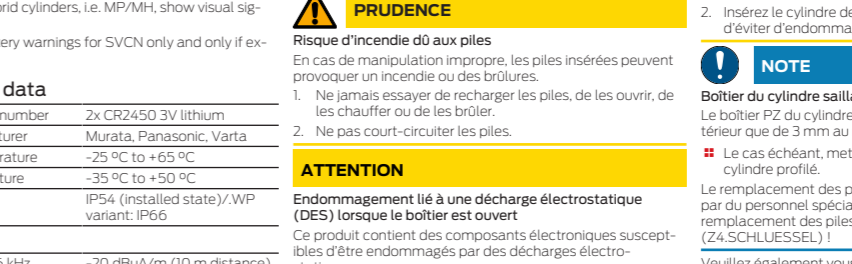
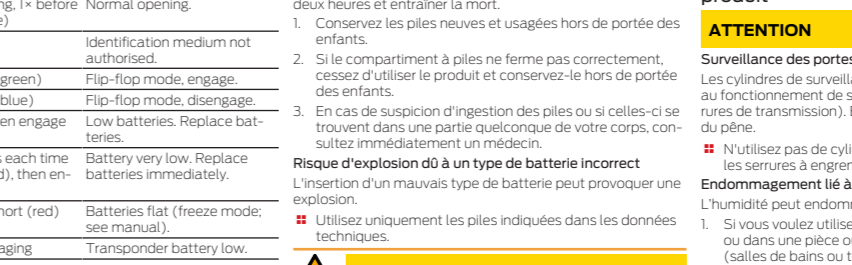
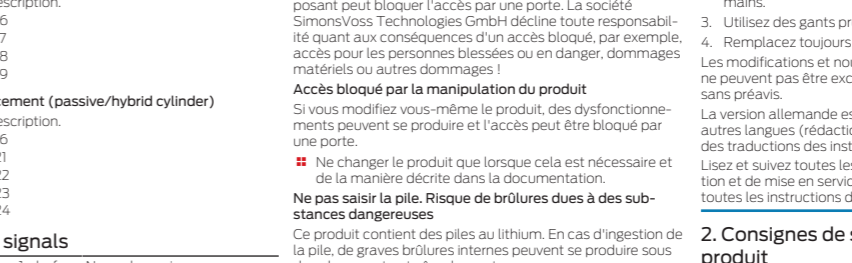
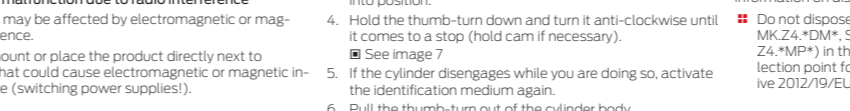
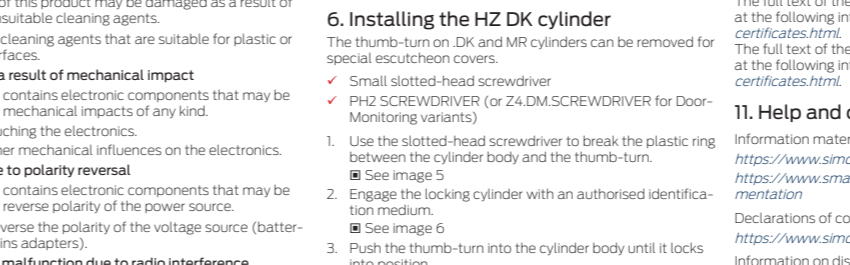
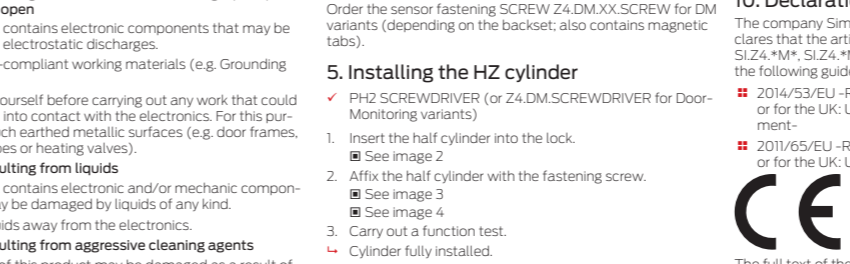
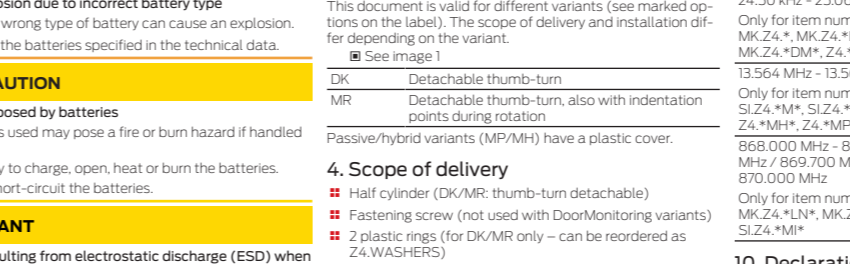
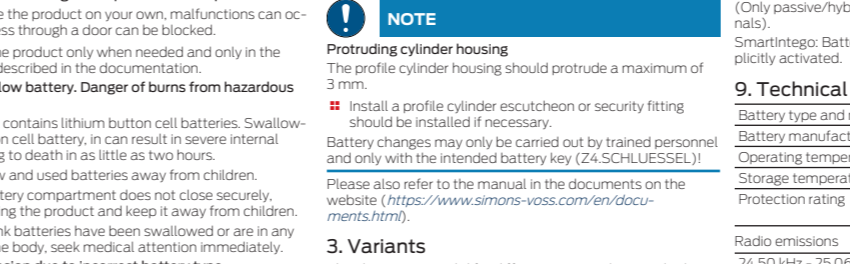
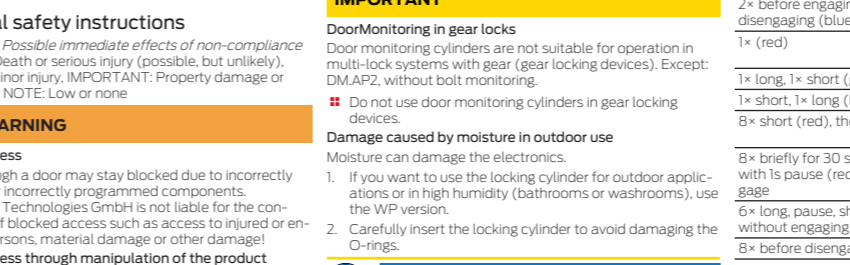
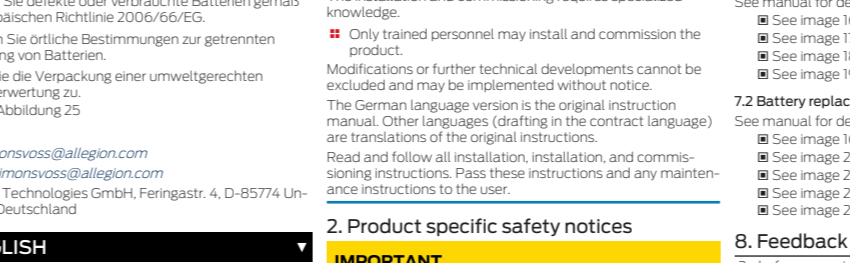
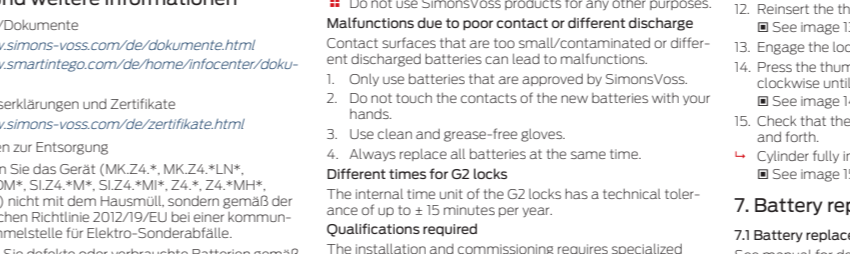
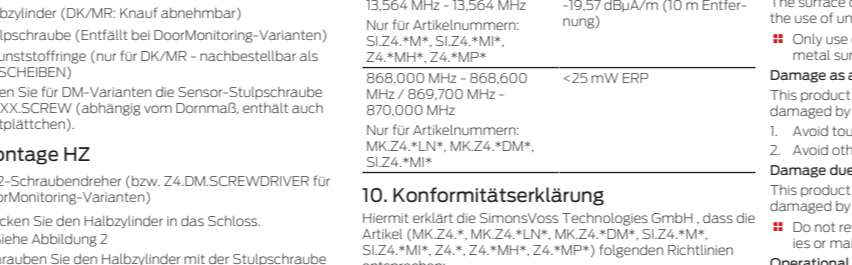
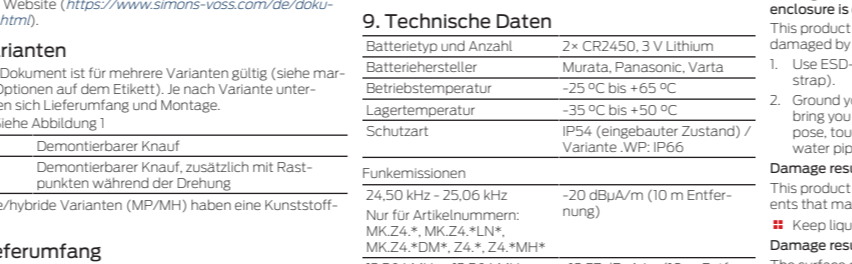
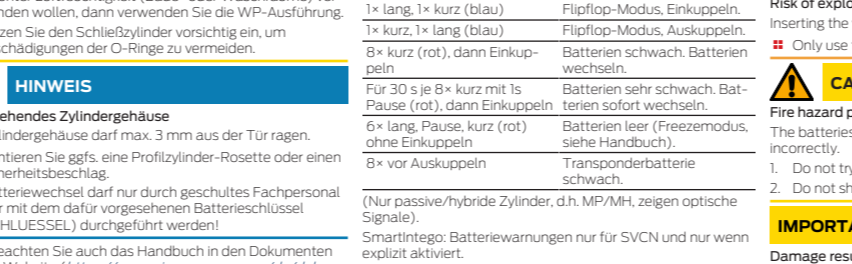
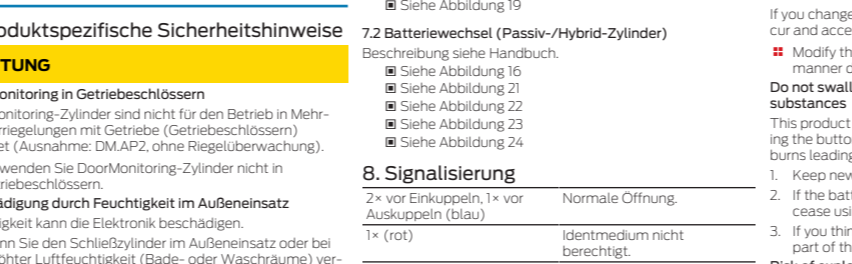
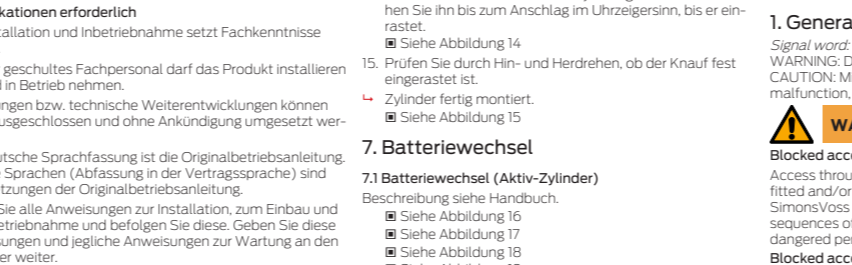
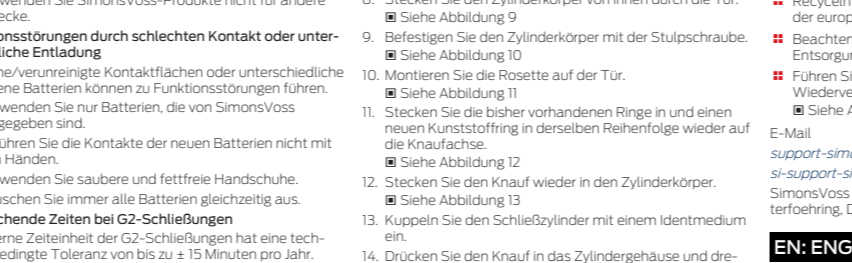
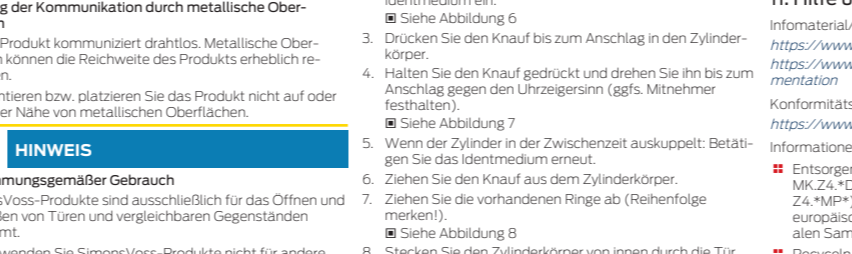
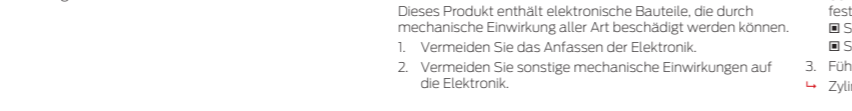
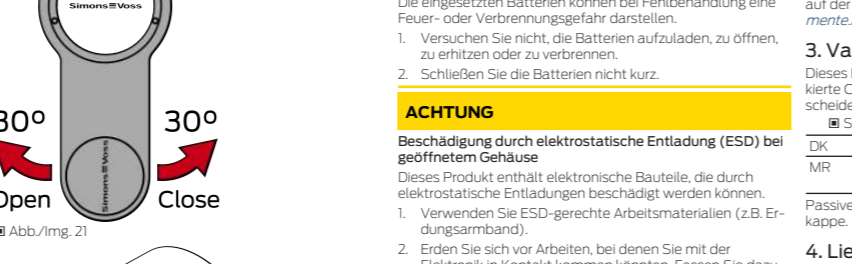
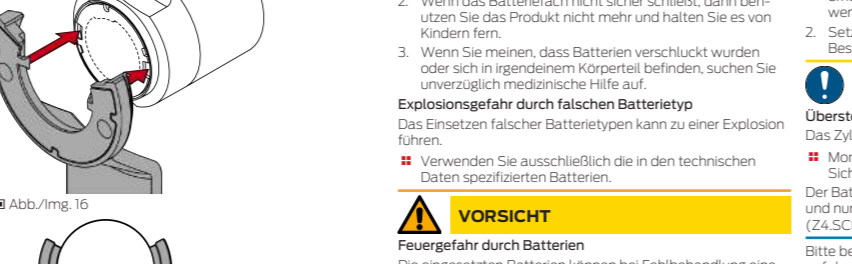
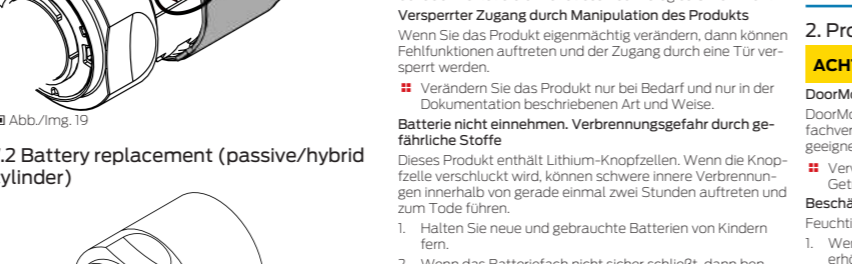
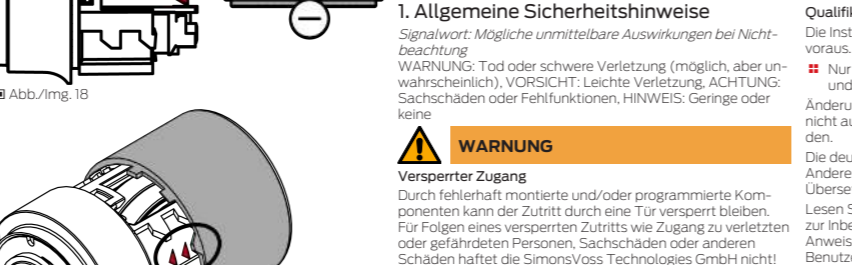
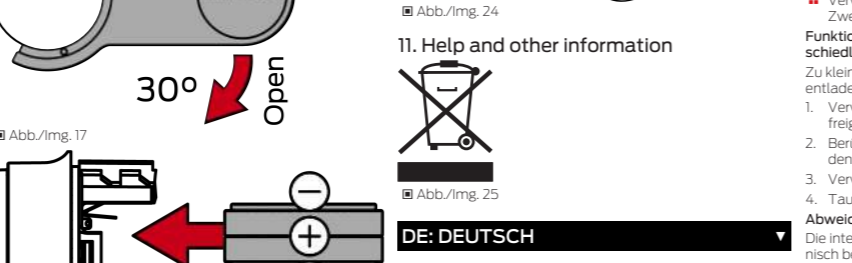
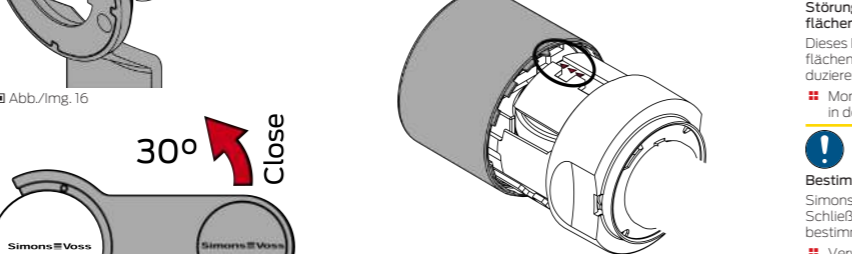
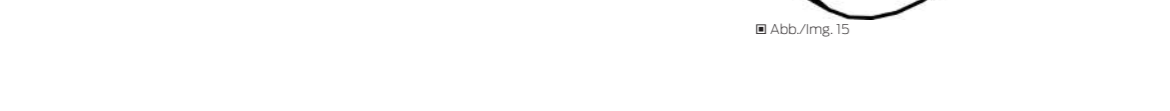
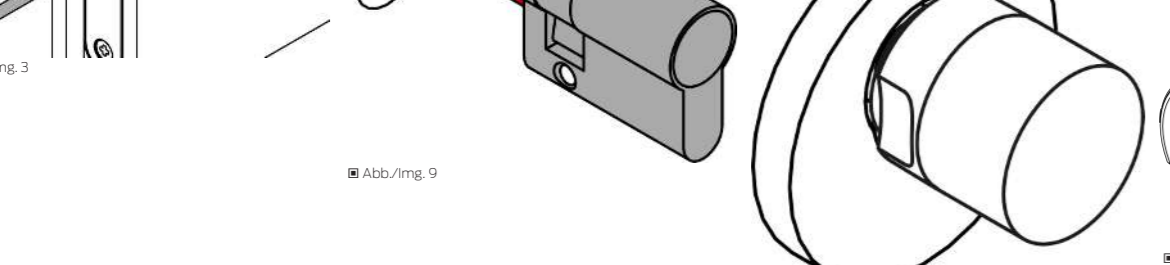
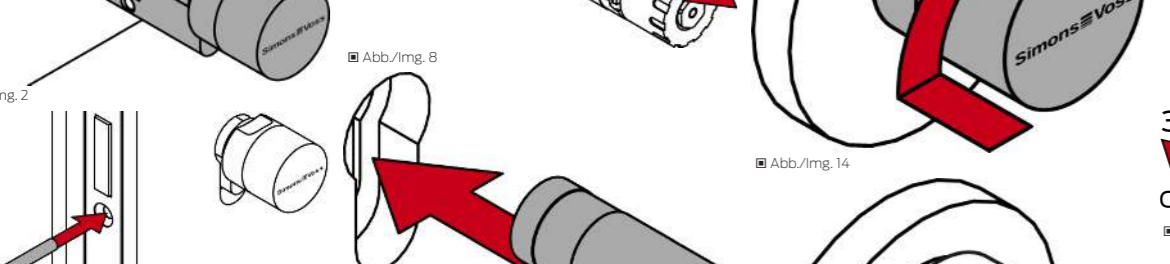
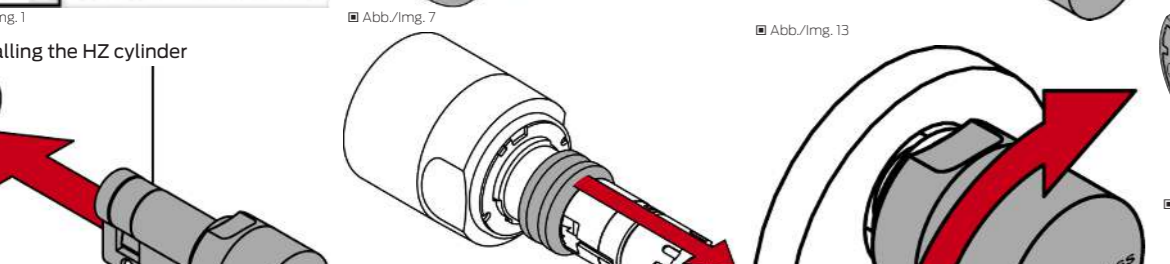
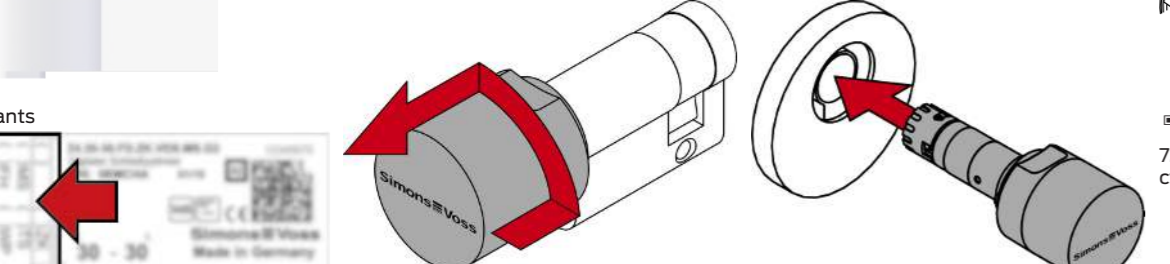
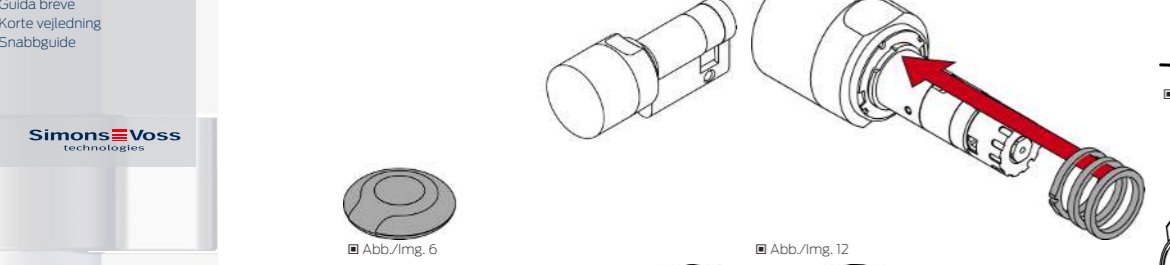
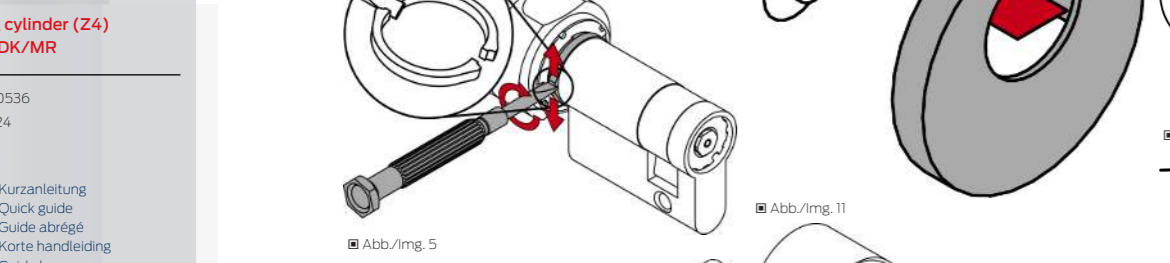

7.4 Battery replacement (passive/hybrid cylinder)

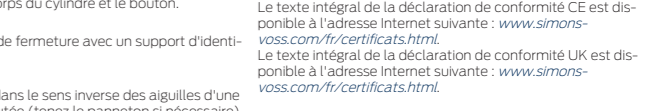
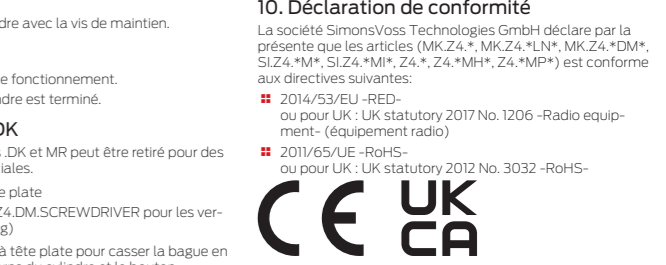
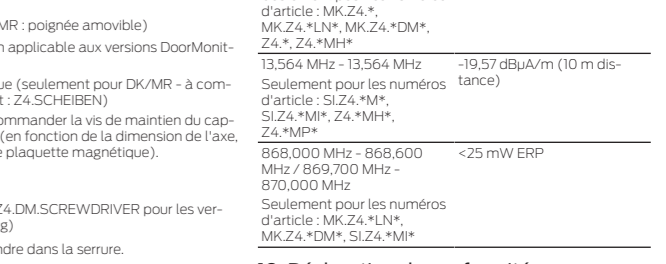
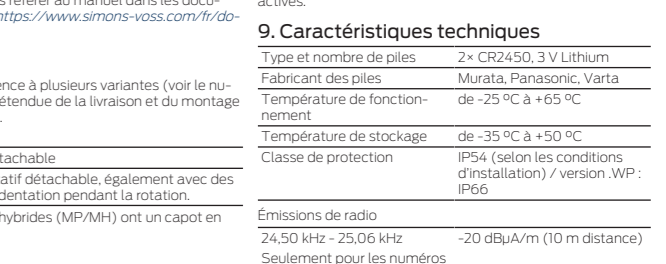
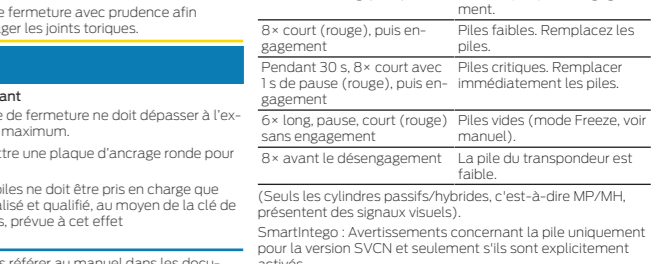
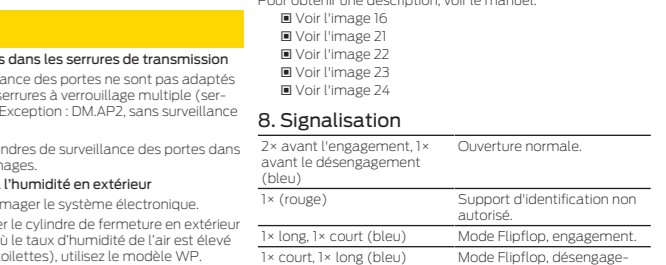
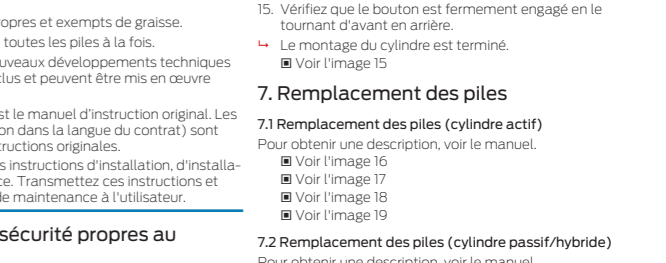
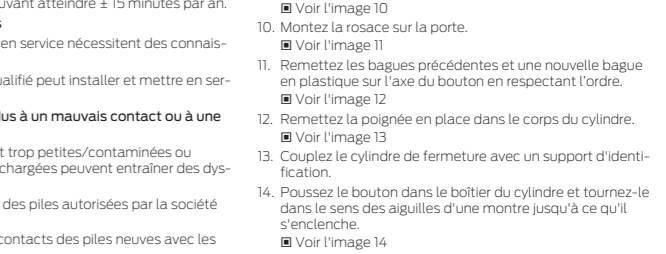
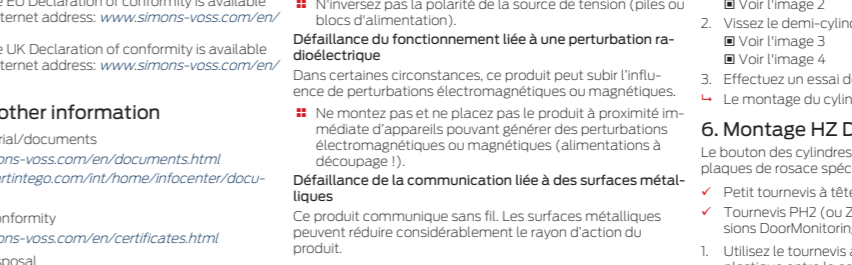
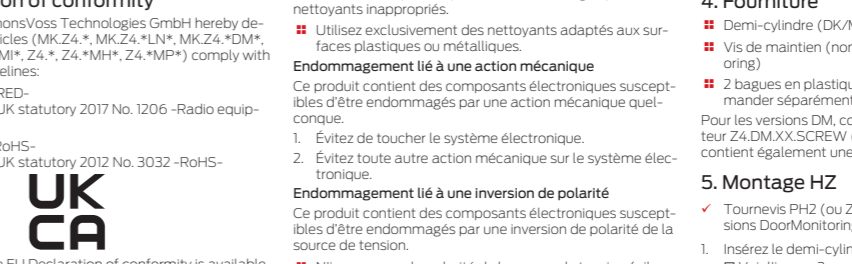
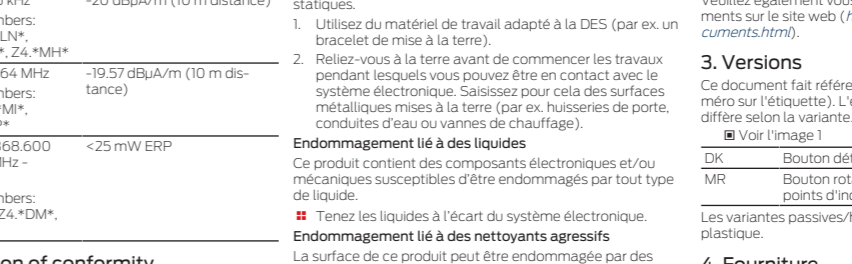
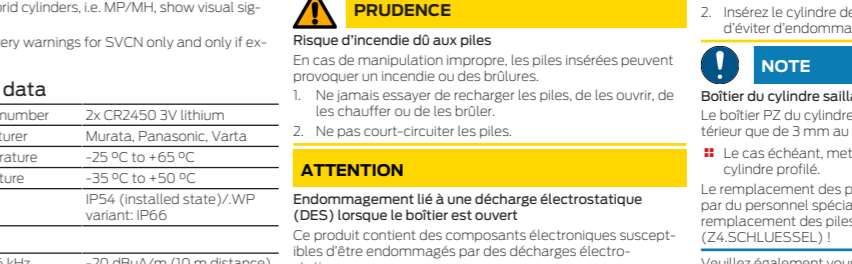
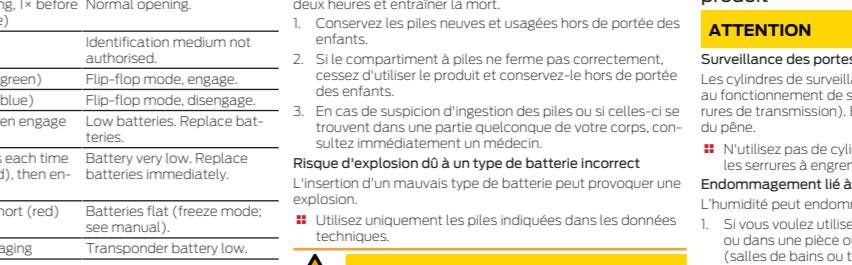
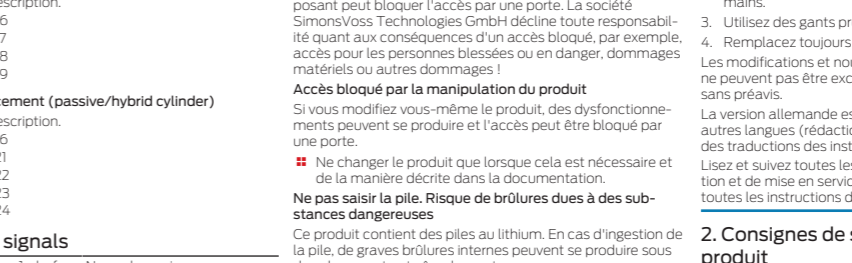
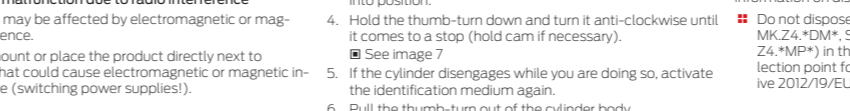
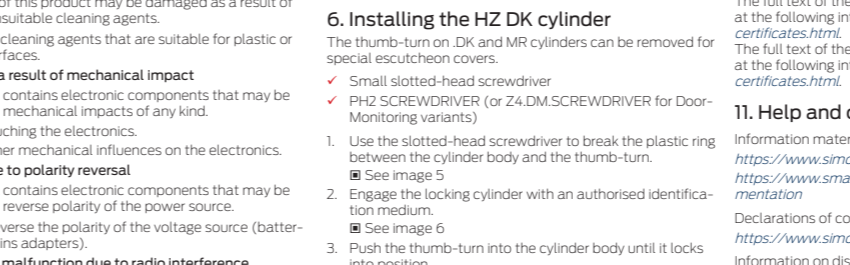
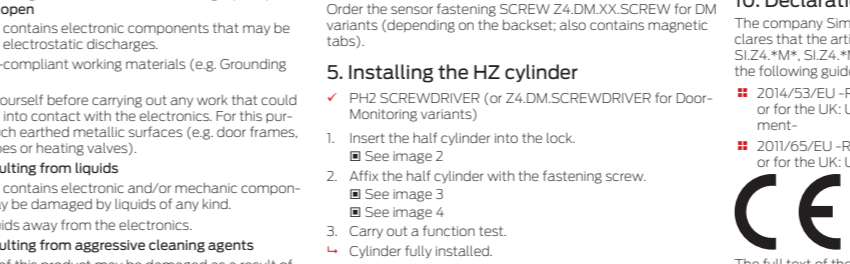
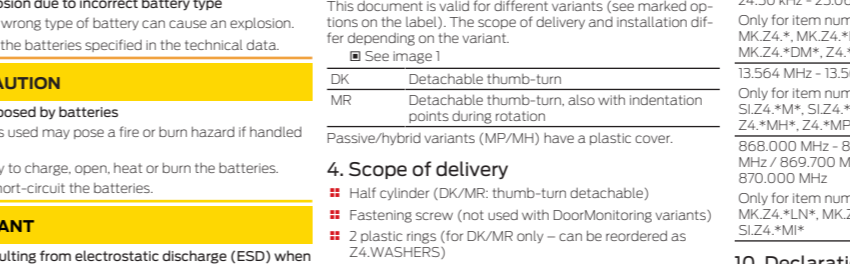
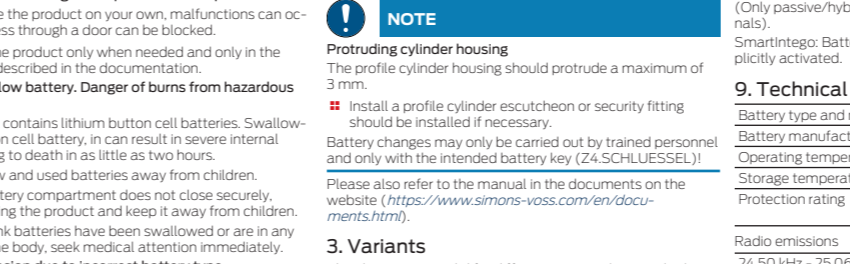
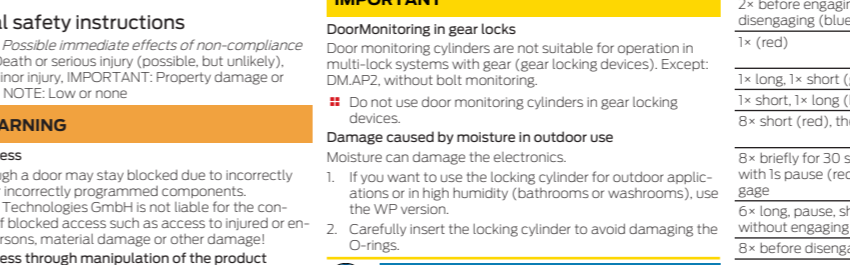
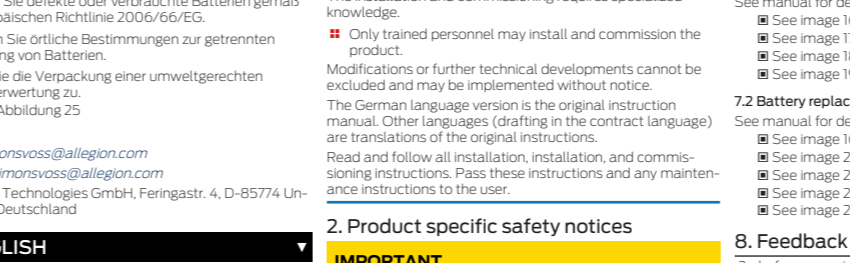
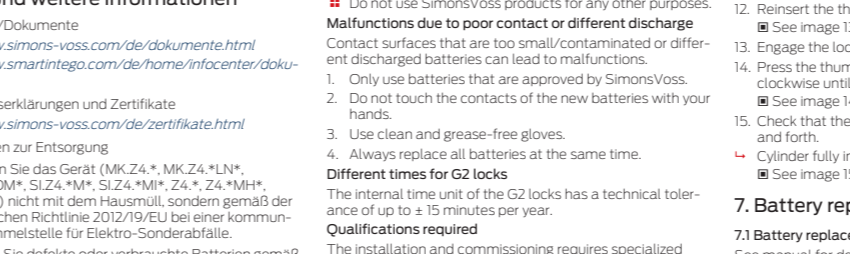
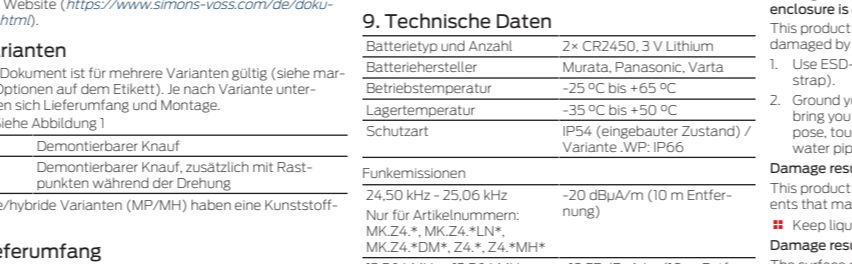
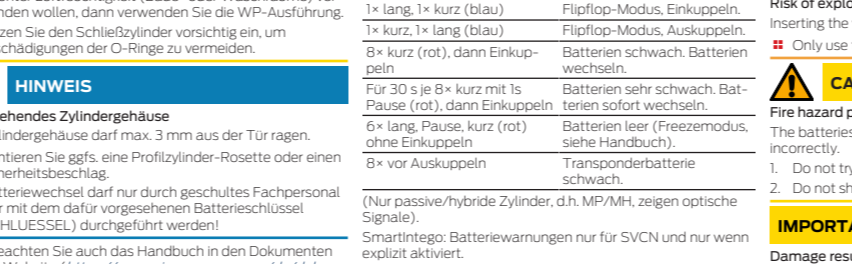
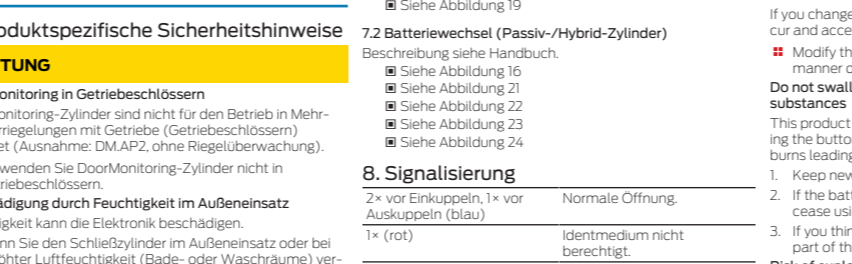
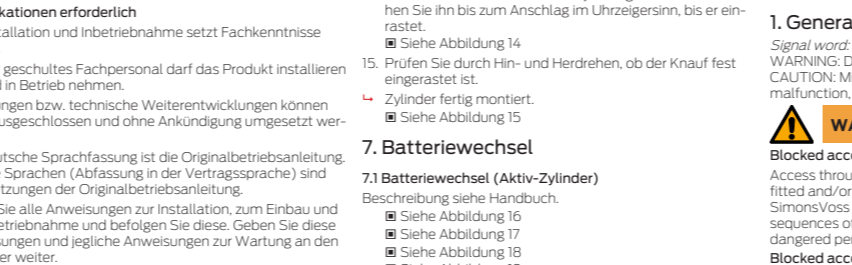
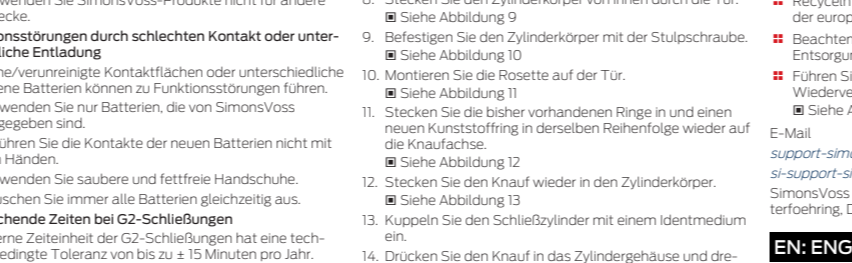
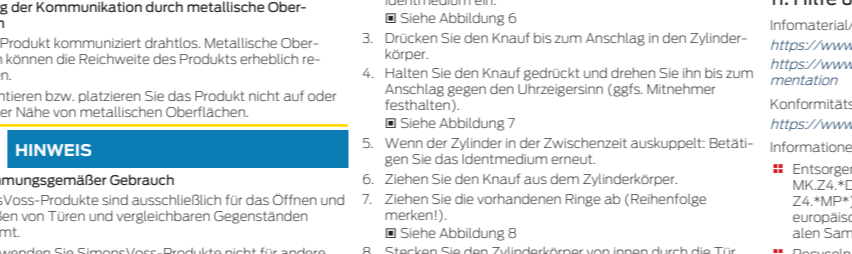
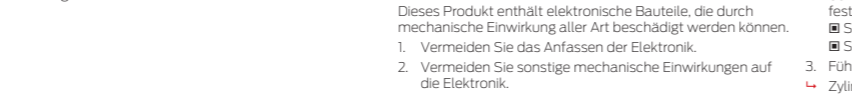
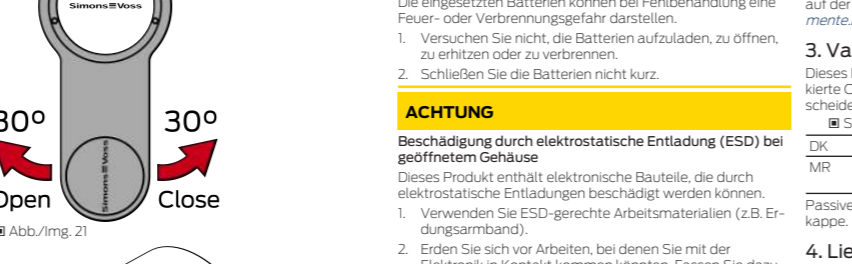
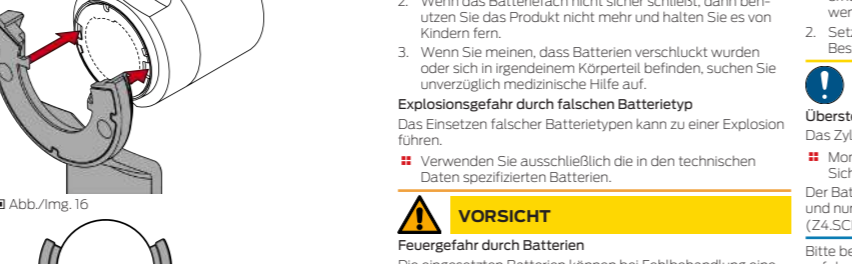
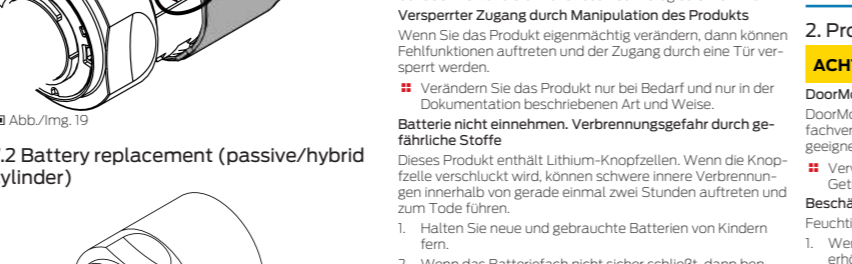
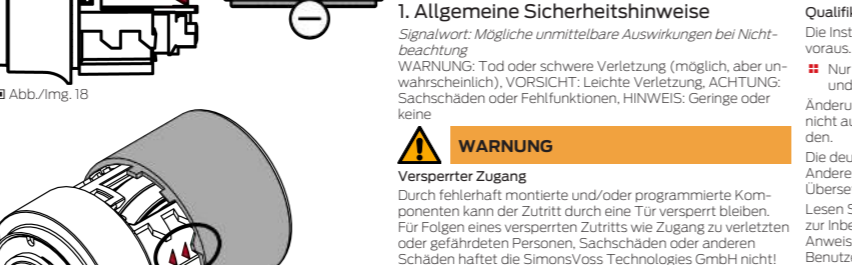
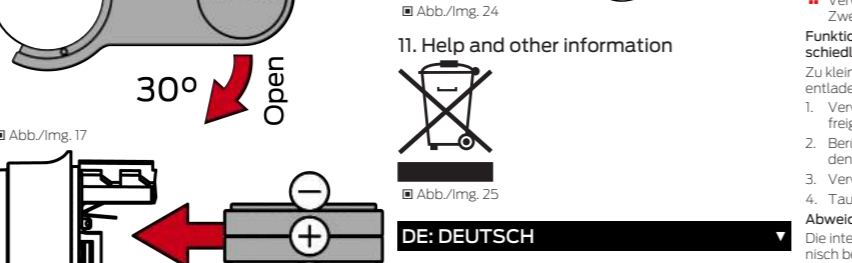
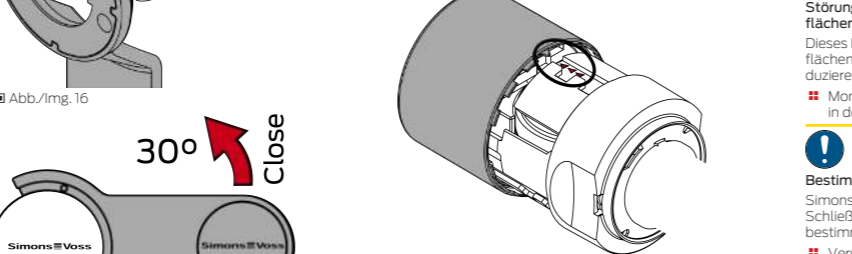
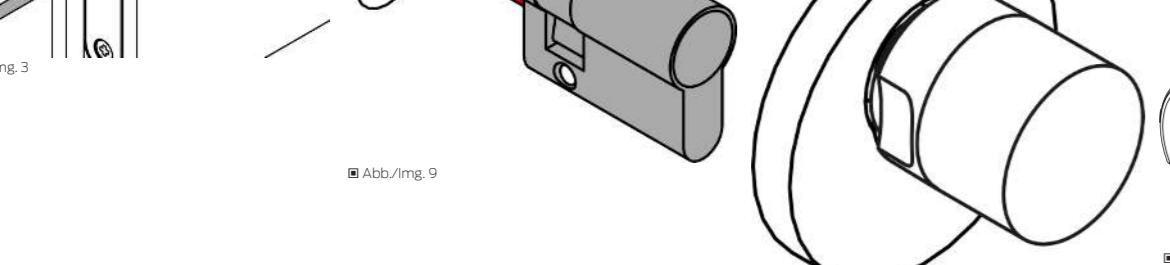
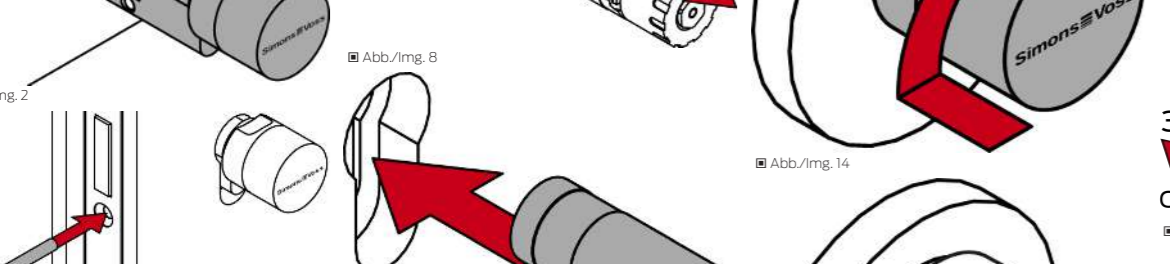
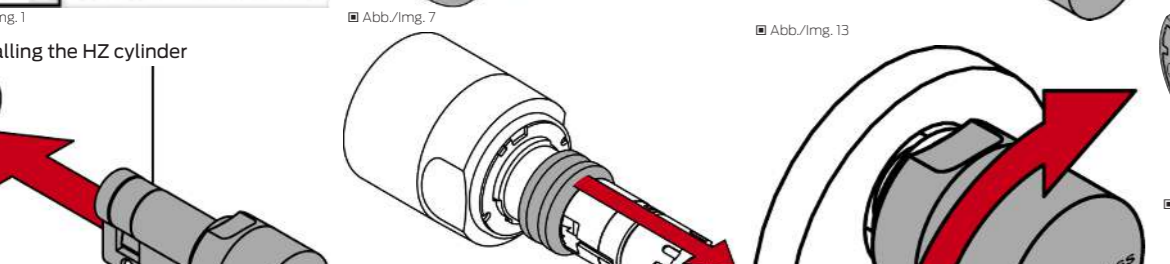
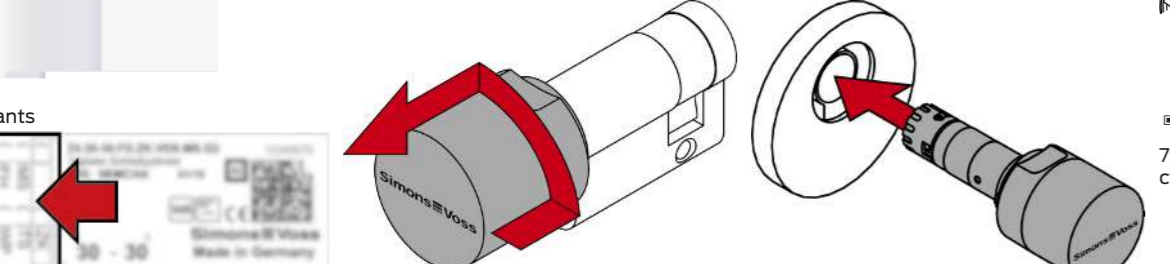
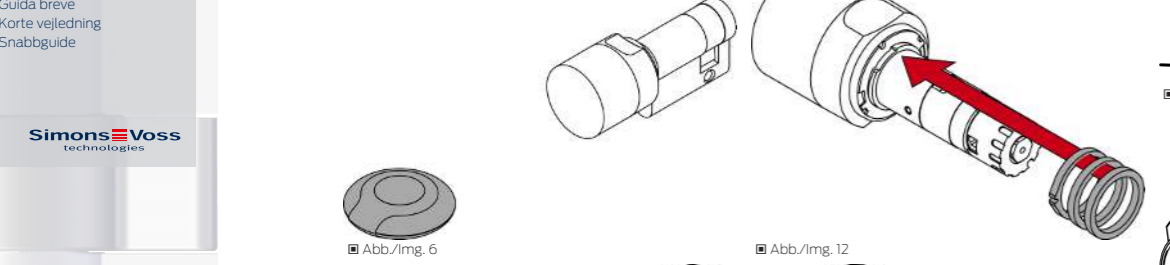
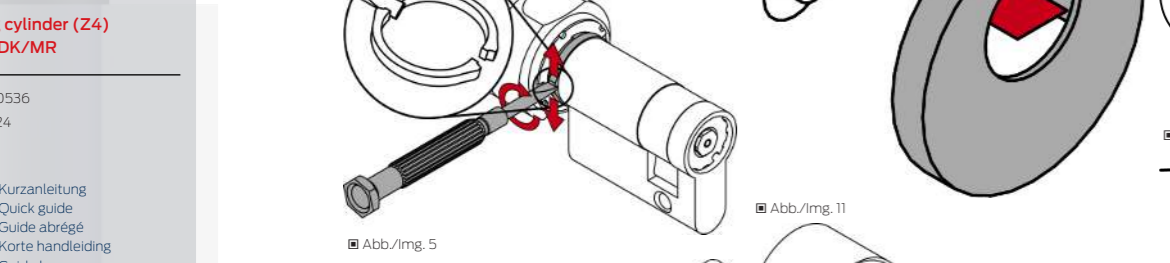

7.5 Battery replacement (active cylinder)

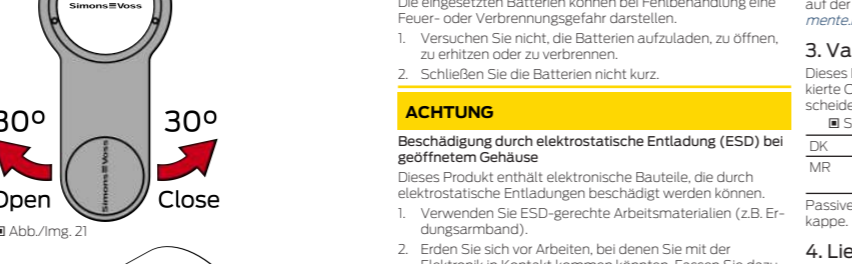
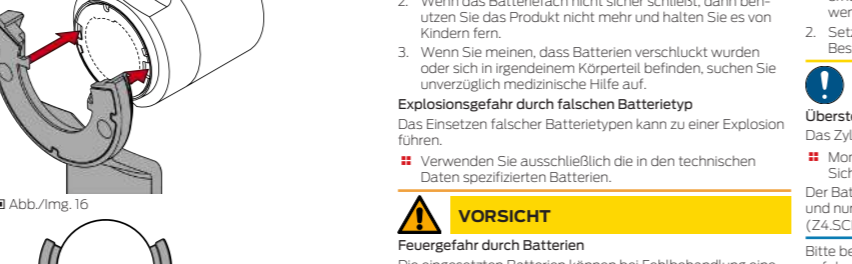
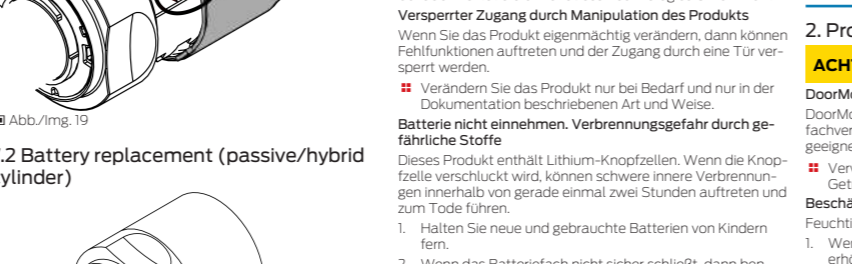
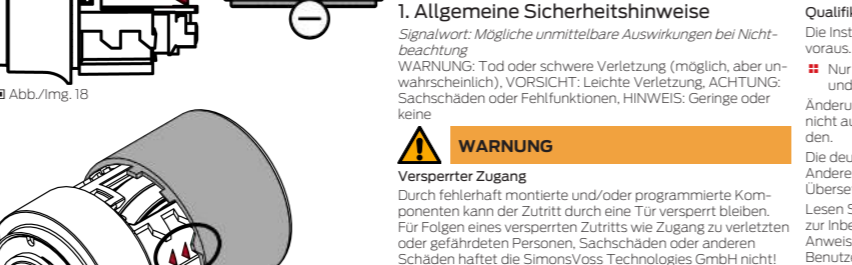
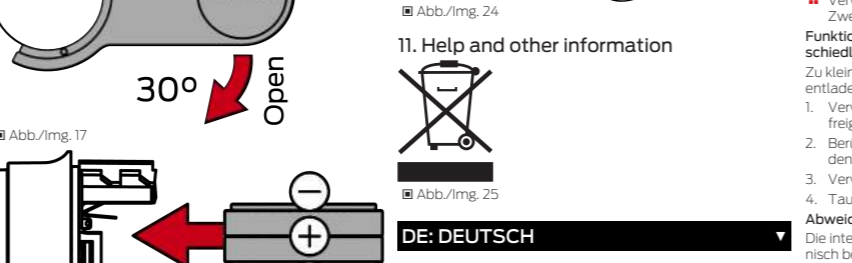
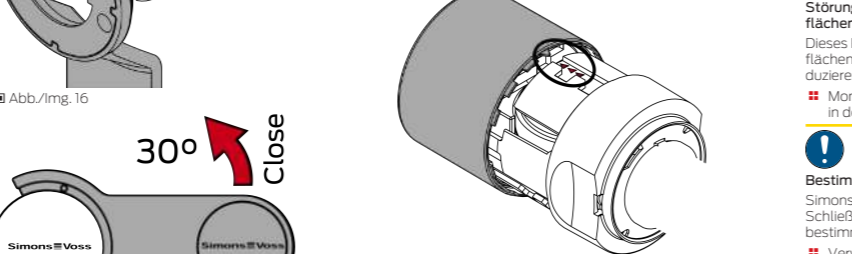
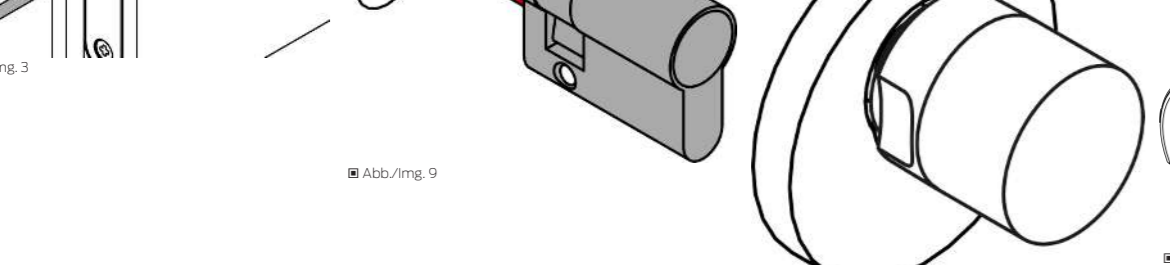
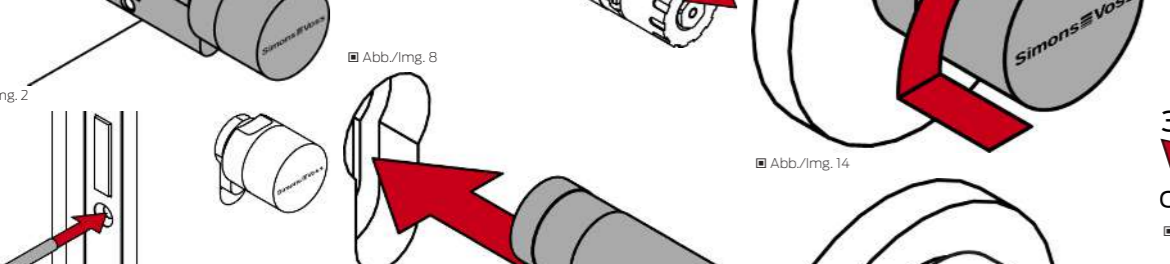
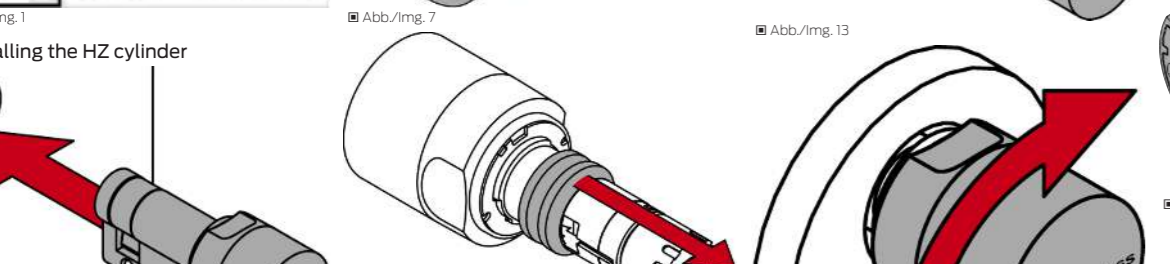
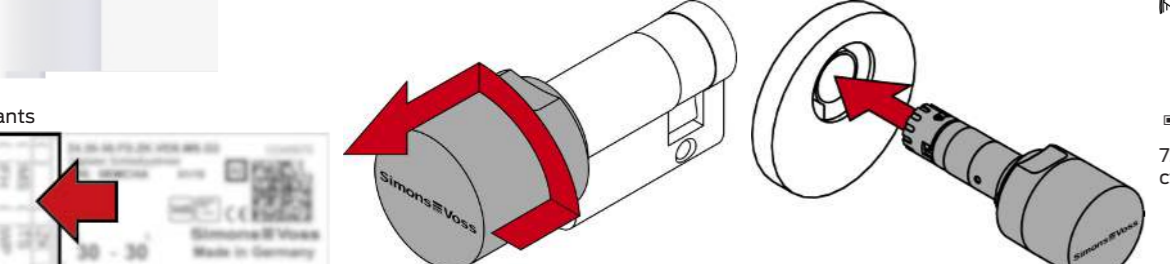
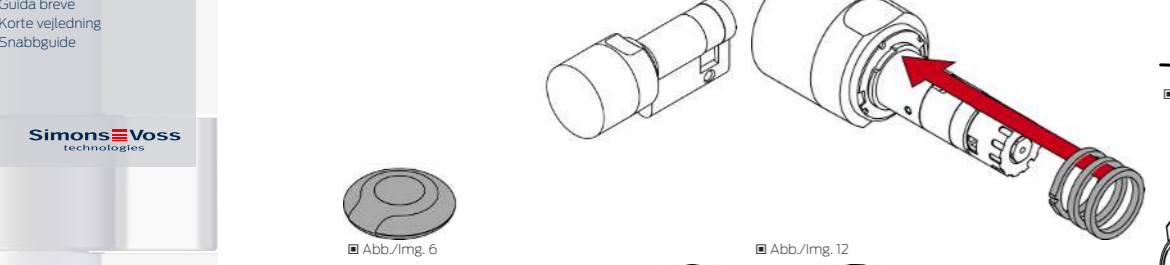
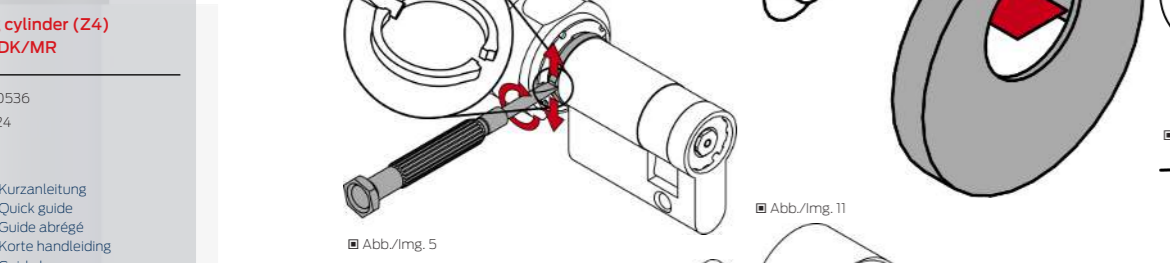
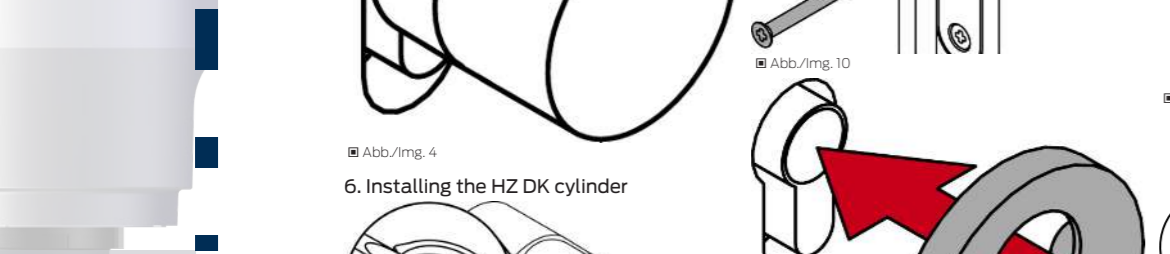

Documentation/documents

https://www.simons-voss.com/fr/documents.html
https://www.smartinfo.com/fr/home/infocenter/docu-mentations

Dichiarazioni di conformità

https://www.simons-voss.com/it/certificati.html

Informations sur l'émalination

Ne jetez pas l'appareil (MK.Z4 - MK.Z4 *LN*, MK.Z4 *DM*, SI.Z4 *M*, SI.Z4 *MH*, Z4 * - Z4 *MP*) avec vos ordures ménagères mais dans un point de collecte communal pour appareils électriques et appareils spécifiques conformément à la directive européenne 2012/19/UE.

Recyclez les piles défectueuses ou usées conformément à la directive européenne 2006/66/CE.

Veillez tenir compte des dispositions locales applicables concernant la collecte séparée des piles.

Recyclez l'emballage d'une manière écologique.

► Voir l'image 25

E-mail *support-simonsvoss@allelion.com* *si-support-simonsvoss@allelion.com*
SimonsVoss Technologies GmbH, Feinringstr. 4, D-85774 Untertöhring, Allemagne

NL: NEDERLANDS

1. Algemene veiligheidsinstructies

Signaalwaard: Mogelijke onmiddellijke gevolgen van niet-naleving

WAARSCHUWING: Dood of ernstig letsel (mogelijk, maar on-waarschijnlijk), VORZIICHTIG: Lichte letsel, LET OP: Materie-lijke schade of storing, **OPMERKING:** Laag of nes

Geblokkeerde toegang
Dour foutief geïnstalleerde en/of geprogrammeerde componenten kan de doorgang door een deur geblokkeerd blijven. Voor hetgeen van een geblokkeerde toegang tot ge-wonden of personen in gevaar, materieel of andere schade, is SimonsVoss Technologies GmbH niet aansprakelijk.

Geblokkeerde toegang als gevolg van manipulatie van het product
Als u het product zelf wijzigt, kunnen er storingen optreden en kan de toegang worden geblokkeerd door een deur.

Vervang het product alleen wanneer dat nodig is en op de manier die in de documentatie wordt beschreven.

Batterijen niet inslikken. Verbrandingsgevaar door slechte stoffen
Dit product bevat lithium-knopcellen. Als de knoopcel wordt ingeslikt, kunnen ernstige verwondingen brandwonden optreden die binnen slechts twee tot de dood veroorzaken.

Als het batterijkw niet goed sluit, mag u het product niet meer gebruiken en moet u het de buurt van kinderen houden.

Breng de profielcilinder behoedzaam aan om beschadiging van de O-ringen te voorkomen.

Als u denkt dat batterijen zijn ingeslikt of in een ander lichaamsdeel terecht zijn gekomen, moet u onmiddellijk medische hulp inroepen.

Explosiegevaar voor verkeerd type batterij
Het plaatsen van het verkeerde type batterij kan een explosie veroorzaken.

Gebruik alleen de in de technische gegevens vermelde batterijen.

VOORZICHTIG

Brandgevaar door batterijen

De gebruikte batterijen kunnen bij verkeerde behandeling tot brand- of verbrandingsgevaar leiden.

1. Probeer niet de batterijen op te laden, open te maken, te verwarmen of te verbranden.

2. U mag de batterijen evenmin kortsluiten.

LET OP

Schade door elektrostatische ontleding (ESD) wanneer de behuizing open is
Dit product heeft elektronische componenten die kunnen worden beschadigd door een elektrostatische ontleding.

1. Maak gebruik van ESD-conforme materialen (bijv. aardingsarmband).

2. Zorg dat u gearbd bent voor werkzaamheden waarbij u niet met de elektronica in contact kunt komen. Gebruik hier-voor geaarde metalen oppervlakken (bijv. Droepstoten, waterleidingen of verwarmingsbuizen).

Beschadiging door vloeistoffen
Dit product heeft elektronische en/of mechanische componen-ten die kunnen worden beschadigd door vloeistoffen.

Beschadiging door bitende reinigingsmiddelen
Het oppervlak van dit product kan worden beschadigd door ongeschikte reinigingsmiddelen.

Beschadiging door mechanische impact
Dit product heeft elektronische componenten die kunnen worden beschadigd door elk type mechanische impact.

1. Vermijd dat u de elektronica aanraakt.

2. Vermijd ook andere mechanische impact op de elektro-nica.

Beschadiging door verwisseling van de polariteit
Dit product bevat elektronische componenten die door ver-wisseling van de polariteit van de voedingsbron beschadigd kunnen worden.

► Verwissel de polariteit van de voedingsbron niet (batter-ijen of netladers).

Storing van het gebruik door verbroken verbinding
Storing van het gebruik door verbroken verbinding kan oed worden door elektromagnetische of magnetische storingen.

► Monteer of plaats het product niet direct in de buurt van apparaten die elektromagnetische of magnetische stori-ngen kunnen veroorzaken (stroombakkeleiders).

Storing van de communicatie door metalen oppervlakken
Dit product communiceert draadloos. Metalen oppervlakken kunnen het zenobereik van het product aanzienlijk vermind-eren.

► Verwijder de aanwezigere ringen (volgorder onthouden).

► Steek het cilinderlichaam van binnen door de deur.

► Ziek afbeelding 9

► Ziek afbeelding 10

► Gebruik SimonsVoss-producten niet voor andere doeleinden.

Storingen door slecht contact of verschillende ontledingn
Contactoppervlakken die te klein/vervuild zijn of verschillende ontledingn accu's kunnen leiden tot storingen.

1. Gebruik alleen batterijen die zijn vriegesjeerd door SimonsVoss.

2. Raak de contacten van de nieuwe batterijen niet met de handen aan.

3. Gebruik schone, vetvrije handschoenen.

4. Vervang daarom alle batterijen tegelijk.

Afwijkinge tijdens het gebruik
De interne laderen van de G2-luistellampen heeft een technisch bepaalde tolerantie van max. ± 15 minuten per jaar. Kwalificaties vereist

De installatie en verificatie/stelling vereist gespecialiseerde kennis. Alleen getraind personeel mag het product installeren en in bedrijf stellen.

Aanpassingen of nieuwe technische ontwikkelingen kunnen niet uitgesloten worden en worden gerealiseerd zonder aankondiging.

De Duitse taalversie is de originele handleiding. Andere talen (opstellen in de contracttaal) zijn vertalingen van de originele instructies.

Lees en volg alle installatie-, installatie- en inbedrijf-stellingsinstructies. Geef deze instructies en eventuele onder-hoedsinstructies door aan de gebruiker.

2. Productspecifieke veiligheidsaanwijzingen

LET OP

DoorMonitoring in motorsloten

Deurbewakingsinloten zijn niet geschikt voor gebruik in meerpunts verdelingen met aandrijving (motorsloten).

► Gebruik geen draadloze toestellen in motorsloten.

Beschadiging door vocht bij buitengebruik

1. Wanneer u de cilinder buiten of bij hoge luchtvochtigheid (badkamer of wasruimte) wilt gebruiken, kies dan voor de WP-uitvoering.

2. Breng de profielcilinder behoedzaam aan om beschadiging van de O-ringen te voorkomen.

3. Als u denkt dat batterijen zijn ingeslikt of in een ander lichaamsdeel terecht zijn gekomen, moet u onmiddellijk medische hulp inroepen.

Explosiegevaar voor verkeerd type batterij
Het plaatsen van het verkeerde type batterij kan een explosie veroorzaken.

Gebruik alleen de in de technische gegevens vermelde batterijen.

OPMERKING

Uitstekende cilinderbehuizing

De behuizing van de profielcilinder moet aan de buitenkant vlak aansluiten en mag maximaal 3 mm uitsteken.

Eventueel moet een rozet voor een profielcilinder of een veiligheidsbeslag worden aangebracht.

Het vervangen van batterijen mag alleen worden gedaan door geschold, deskundig personeel en enkel met de hier-voor bestemde batterijsoort (Z4-SCHLUESSEL).

Zie ook de manual in de documenten op de website (*https://www.simons-voss.com/nl/documents.html*).

3. Uitvoeringen

Dit document is geldig voor meerdere uitvoeringen (zie de ge-markeerde opties op het etiket). Afhankelijk van de uitvoering zijn de leveringsomvang en de montage verschillend.

► Ziek afbeelding 1

DK	Demonteerbare knop	
MR	Demonteerbare knop, extra met ver-grendelpunten tijdens het draaien	

Passieve/hybride uitvoeringen (MP/MH) hebben een kunst-stof kapje.

4. Leveromvang

► Halve cilinder (DK/MR: knop afneembaar)

► Stiftschroef (vervalt bij DoorMonitoring-uitvoeringen)

2. Kunststof ringen (alleen voor DK/MR – na te bestellen als Z4-SCHIEBEN)

Bestel voor DM-uitvoeringen de sensor-stiftschroef Z4.DM.XX.SCREW (afhankelijk van de doormaat, bevat ook magneetplaatje).

5. Montage HC

► PH2-schroevendraaier (resp. Z4.DM.SCREWDRIJVER voor DoorMonitoring-uitvoeringen)

1. Steek de halve cilinder in het slot.

► Ziek afbeelding 2

2. Schroef de halve cilinder vast met de stiftschroef.

► Ziek afbeelding 3

3. Voer de cilinder in het slot uit.

► Montage van de cilinder afgeordn.

6. Montage HC DK

Voor speciale rozetafbeeldingen kan de knop van de DK- en MR-cilinders worden verwijderd.

► Kleine Schroevendraaier (resp. Z4.DM.SCREWDRIJVER voor DoorMonitoring-uitvoeringen)

1. Verbreek de kunststof ring tussen het cilinderlichaam en de knop met de schroevendraaier.

► Ziek afbeelding 5

2. Koppel de cilinder in met een bevoegd identifi-catiemedium

► Ziek afbeelding 6

3. Druk de knop tot de aanslag in het cilinderlichaam.

4. Hou de knop ingedrukt en draai hem tot de aanslag link-som (evt. meermalen vasthouden).

► Ziek afbeelding 7

► Non montare o posizionare il prodotto sopra o vicino a su-perfici metalliche.

► Voer het apparaat (MK.Z4 - MK.Z4 *LN*, MK.Z4 *DM*, SI.Z4 *M*, SI.Z4 *MH*, Z4 * - Z4 *MP*) niet af als huishoudelijk afval, maar overeenkomstig de Europese Richtlijn 2012/19/UE bij een gemeentelijke inzamel-punt voor speciaal elektrotoestelafval.

► Zorg voor recycling van defecte of gebruikte batterijen volgens de Europese Richtlijn 2006/66/EG.

► Neem de plaatselijke bepalingen in acht voor de geschei-den afvoer van batterijen.

► Voer de verpakking af naar een instantie voor milieuvriendelijke recycling.

► Ziek afbeelding 25

E-mail *support-simonsvoss@allelion.com* *si-support-simonsvoss@allelion.com*
SimonsVoss Technologies GmbH, Feinringstr. 4, 85774 Untertöhring, Duitsland

IT: ITALIANO

1. Avvisi di sicurezza generali

Parola segnale: Possibili effetti immediati di non conformità AVVERTENZA: Morte o lesioni gravi (possibili, ma improbabili). *ATTENZIONE:* Lesione minori, AVVISO: Danni materiali o malfunzionamento. *NOTA:* Basso o no

Non si escludono modifiche o perfezionamenti tecnici, anche senza preavviso.

La versione in lingua tedesca e il manuale di istruzioni originale. Altre lingue (reduzione nella lingua del contratto) sono traduzioni delle istruzioni originali.

Leggere e seguire tutte le Istruzioni di installazione, installa-zione e messa in servizio. Passare queste istruzioni e tutte le istruzioni di manutenzione all'utente.

2. Avvertenze di sicurezza specifiche del prodotto

AVVISO
DoorMonitoring nelle serrature ad ingranaggi

I cilindri di monitoraggio delle porte non sono adatti al funzio-namento a chiusura multipunto con ingranaggio (serrature a ingranaggi). Eccezione: DM.AP2, senza monitoraggio chiav-estivo.

► Non utilizzare i cilindri di monitoraggio delle porte nelle serrature ad ingranaggi.

Danni causati dall'umidità in caso di impiego all'aperto
L'umidità può danneggiare l'elettronica.

1. Se il cilindro di chiusura viene utilizzato all'aperto in un ambiente con un elevato grado di umidità (bagni o toilette), usare la versione WP.

2. Inserire il cilindro di chiusura con cautela, per evitare danni agli O-ring.

! NOTA

Allungamento del cilindro sporgente
All'esterno, l'alloggiamento del cilindro profilato dovrebbe sporgere al massimo di 3 mm.

► All'occorrenza applicare una rondella per il cilindro profilato o un investimento di sicurezza.

La sostituzione della batteria deve essere effettuata esclusi-vamente da personale specializzato e addestrato e solo con l'apposita chiave per batterie (Z4-SCHLUESSEL).

► Vedere illustrazione 1

► (Solo i cilindri passivo/ibridi, cioè MP/MH, mostrano segnali ottici).

SmartIntego: Avvisi batteria solo per SVCN e solo se esplici-tamente attivati.

► Se prega di fare riferimento anche al manuale nei documenti prelevati sul sito web (*https://www.simons-voss.com/it/do-cument.html*).

3. Varianti

Il presente documento è valido per diverse varianti (vedere le opzioni contrassegnate sull'etichetta). La consegna e l'installa-zione differiscono a seconda della variante.

► Vedere illustrazione 1

DK Manopola smontabile

MR Manopola smontabile, inoltre con punti di scatto durante la rotazione

Le varianti passiva/ibrida (MP/MH) hanno un cappuccio in plastica.

► Brag ESD-estetiche arbetsmaterialer (f.eks. jordfor-bindelsesbånd).

► Opnet jordforbindelse for arbejde, hvor du kan komme i kontakt med elektroniken. Indfat i denne forbindelse jordforbundne metaloverflader (f.eks. dokkeme, vandrer eller varmemetaller).

Beskadigelse på grund af væske
Dette produkt indeholder elektroniske og/eller mekaniske komponenter, som kan blive beskadiget på grund af alle typer væsker.

► Hold væsker væk fra elektroniken.

Beskadigelse på grund af aggressive rengøringsmidler
Produktets overflade kan blive beskadiget på grund af uegnede rengøringsmidler.

► Brug kun rengøringsmidler, der er velegnede til kunststof- og metaloverflader.

Beskadigelse på grund af fejltillutning
Dette produkt indeholder elektroniske komponenter, som kan blive beskadiget på grund af elektrostatiske afladning (ESD) med huset åbent

Dette produkt indeholder elektroniske komponenter, som kan blive beskadiget på grund af elektrostatiske afladning (ESD) med huset åbent

Dette produkt indeholder elektroniske komponenter, som kan blive beskadiget på grund af alle typer mekanisk påvirkning

► Våd eller våde elektronikker kan knognebrøt for. DK- og MR-cylinderen fjernes.

► Lillie knokværettrækker.

► Den produkt indeholder elektroniske komponenter, som kan blive beskadiget på grund af fejltillutning

Dette produkt indeholder elektroniske komponenter, som kan blive beskadiget på grund af elektrostatiske afladning (ESD) med huset åbent

Dette produkt indeholder elektroniske komponenter, som kan blive beskadiget på grund af alle typer mekanisk påvirkning

► Våd eller våde elektronikker kan knognebrøt for. DK- og MR-cylinderen fjernes.

► Lillie knokværettrækker.

► Den produkt indeholder elektroniske komponenter, som kan blive beskadiget på grund af fejltillutning

Dette produkt indeholder elektroniske komponenter, som kan blive beskadiget på grund af elektrostatiske afladning (ESD) med huset åbent

Dette produkt indeholder elektroniske komponenter, som kan blive beskadiget på grund af alle typer mekanisk påvirkning

► Våd eller våde elektronikker kan knognebrøt for. DK- og MR-cylinderen fjernes.

6. Estrane il pannello dal corpo del cilindro.

7. Rimuovere gli anelli esistenti (ricordare l'ordine).

► Vedere illustrazione 8

8. Spingere il corpo del cilindro attraverso la porta dall'in-terno.

► Vedere illustrazione 9

9. Fissare il corpo del cilindro con la vite di ritenuta.

► Vedere illustrazione 10

10. Montare la rosetta sulla porta con un mezzo di identi-ficazione.

11. Infilare gli anelli precedenti e un nuovo anello di plastica sull'asse del pannello nello stesso ordine.

► Vedere illustrazione 12

12. Rendere il pannello nel corpo del cilindro.

► Vedere illustrazione 13

13. Accoppiare il cilindro di chiusura con un mezzo di identi-ficazione.

14. Spingere il pannello nell'alloggiamento del cilindro e girar-lo in senso orario fino a quando non scatta in posizione.

► Vedere illustrazione 14

15. Controllare che il pannello sia saldamente inserito gran-do avanti e indietro.

► Il cilindro è completamente montato.

► Vedere illustrazione 15

7. Sostituzione della batteria

7.1 Sostituzione della batteria (cilindro attivo)

Per la descrizione, consultare il manuale.

► Vedere illustrazione 16

► Vedere illustrazione 17

► Vedere illustrazione 18

► Vedere illustrazione 19

7.2 Sostituzione della batteria (cilindro passivo/ibrido)

Per la descrizione, consultare il manuale.

► Vedere illustrazione 16

► Vedere illustrazione 17

► Vedere illustrazione 18

► Vedere illustrazione 23

8. Segnalazione

2-8 prima dell'accoppia-mento. Apertura normale.

1-1 (rosso)

Mezzo d'identificazione non autorizzato.

Modalità Filiofp, accoppia-mento.

Modalità Filiofp, disaccoppia-mento

Batteria scarica. Sostituire le batterie.

Batteria molto scarica. Sostituire immediatamente le batterie.

Batteria scarica (modalità Freeze, vedere il manuale).

Batteria trasponder scarica.

Mezzo d'identificazione non autorizzato.

Modalità Filiofp, accoppia-mento.

Modalità Filiofp, disaccoppia-mento

Batteria molto scarica. Sostituire immediatamente le batterie.

Batteria scarica (modalità Freeze, vedere il manuale).

Batteria trasponder scarica.

Mezzo d'identificazione non autorizzato.

Modalità Filiofp, accoppia-mento.

Modalità Filiofp, disaccoppia-mento

Batteria molto scarica. Sostituire immediatamente le batterie.

Batteria scarica (modalità Freeze, vedere il manuale).

Batteria trasponder scarica.

Mezzo d'identificazione non autorizzato.

Modalità Filiofp, accoppia-mento.

Modalità Filiofp, disaccoppia-mento

Batteria molto scarica. Sostituire immediatamente le batterie.

Batteria scarica (modalità Freeze, vedere il manuale).

Batteria trasponder scarica.

Mezzo d'identificazione non autorizzato.

Modalità Filiofp, accoppia-mento.

Modalità Filiofp, disaccoppia-mento